

# Dynamic Visualization of Annual Building Simulation Data

**15<sup>th</sup> Annual Radiance Workshop – Padua, Italy**

Alen Mahić, Energy Studies in Buildings Laboratory  
University of Oregon



[illegible]

# Purpose and scope

- Quantification of energy savings attributed to blinds system.
- Annual daylight and energy modeling of 9-storey office building with roughly 325,000 square feet of floor area.
- Both models to include Lutron motorized shades (MechoShade) and automated controls.



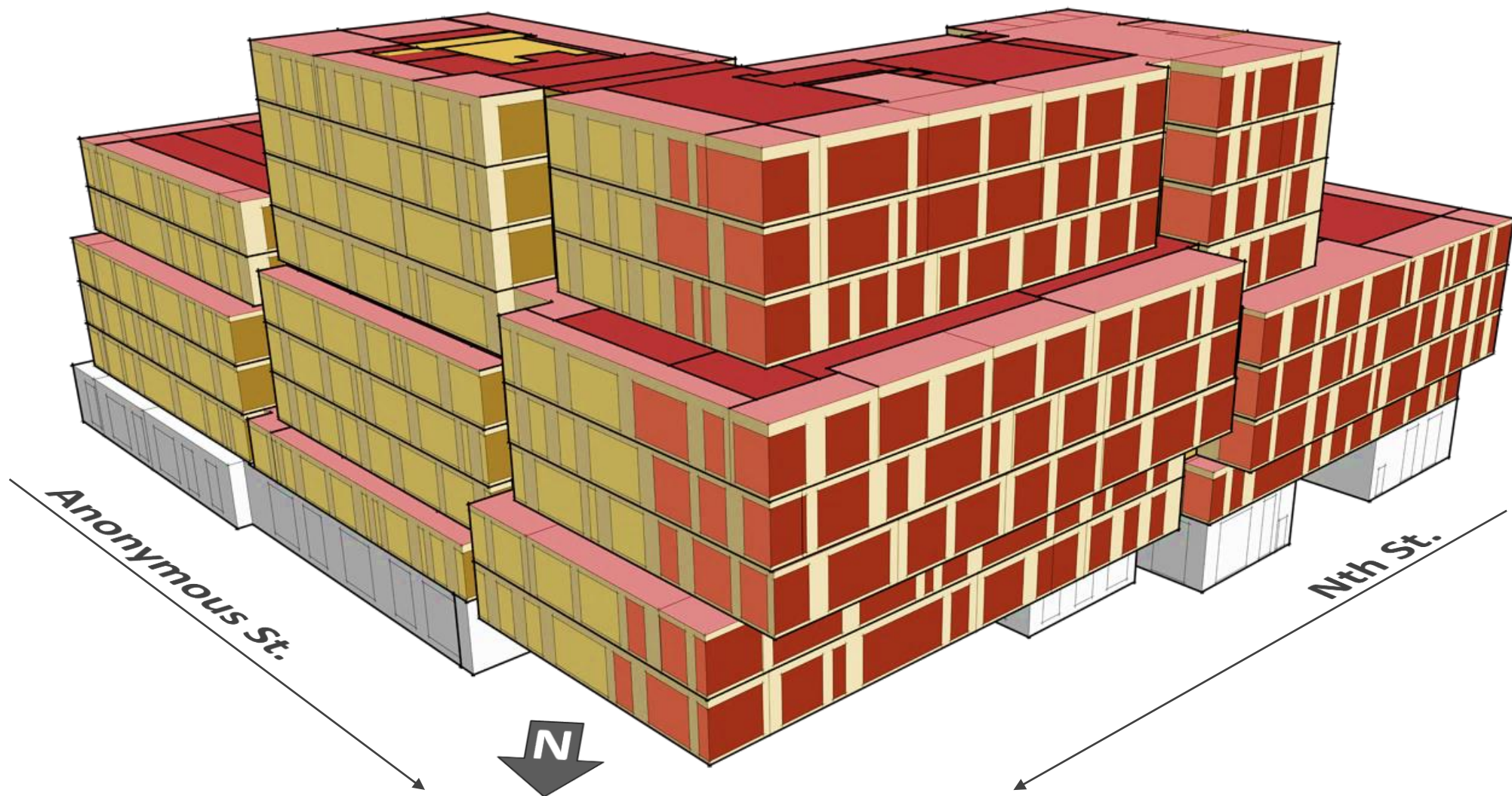



# Daylight zoning

- Blinds operation based on zoning of spaces and window groups.
- Four spatial zones per floor.
- Windows grouped as designed and operated as part of each spatial zone.
- 4'x4' analysis grid spacing.
- Cores excluded.

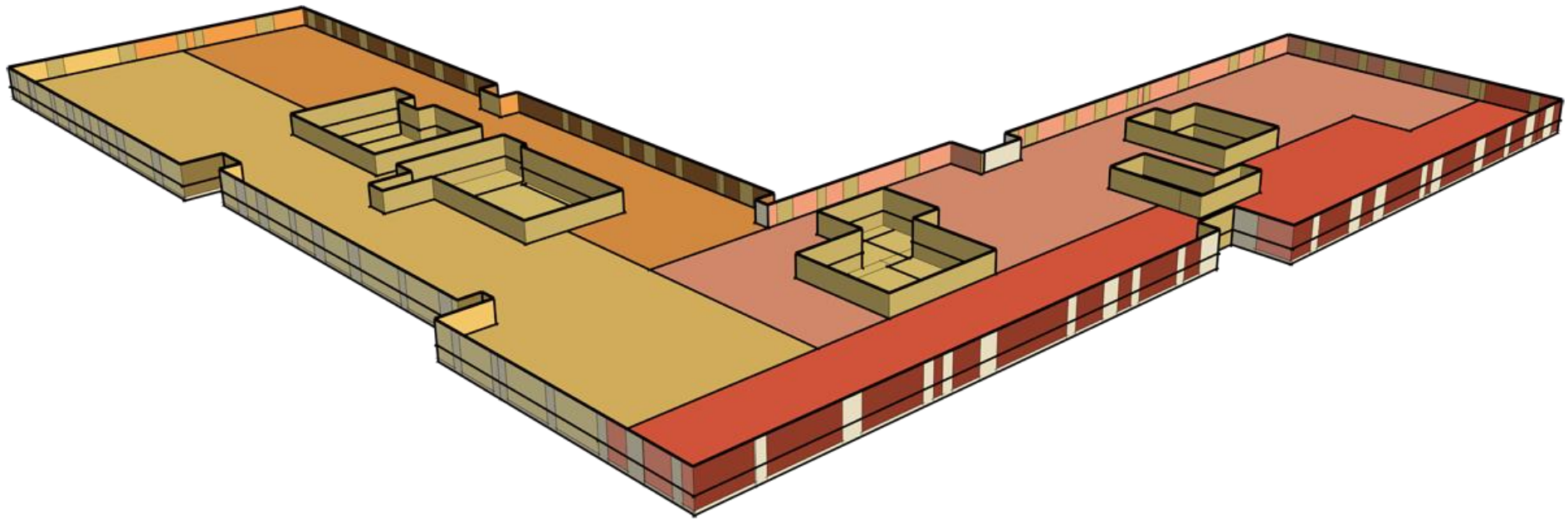

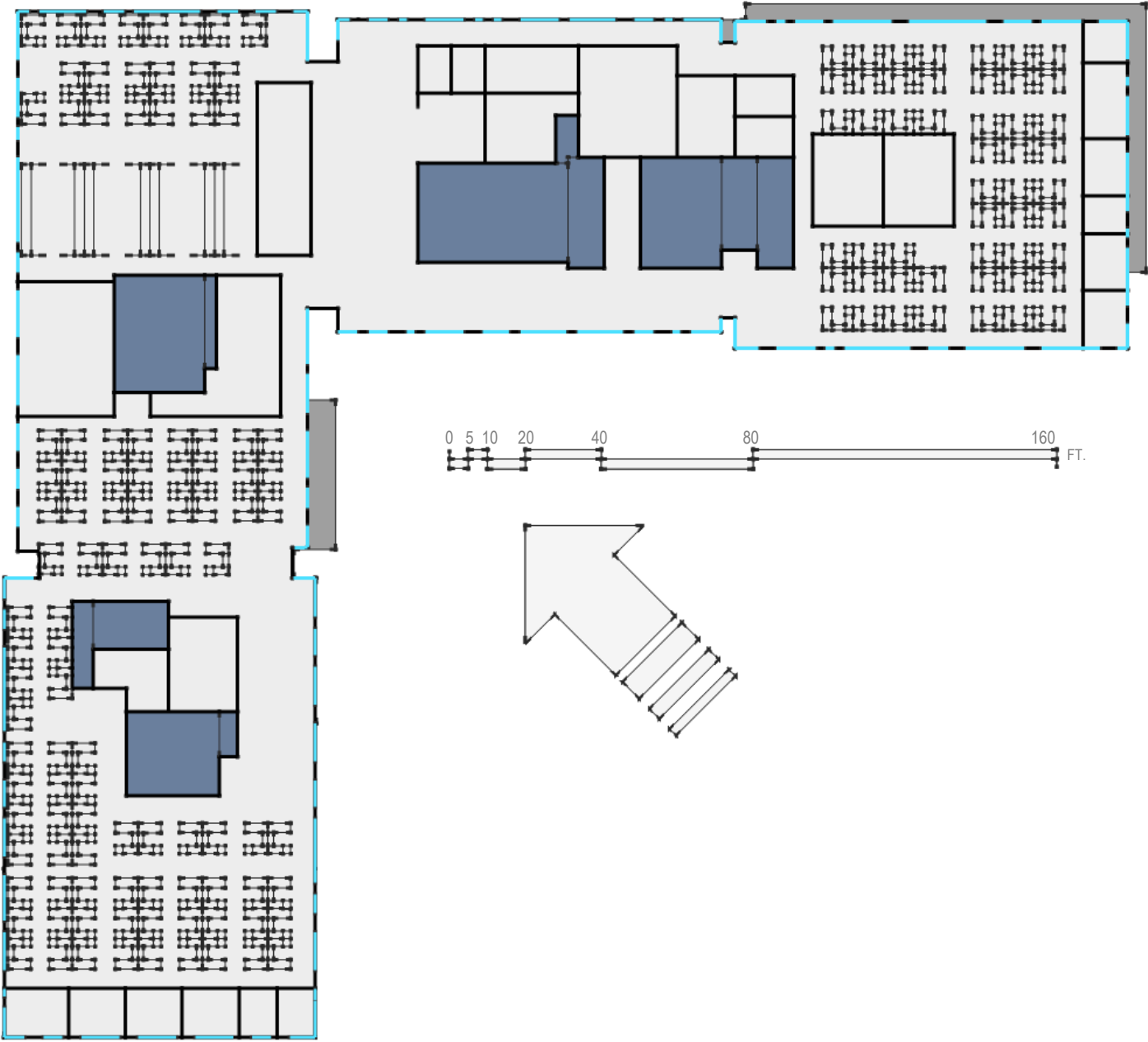

# Daylight zoning

14,386 analysis points. (4'x4' grids)

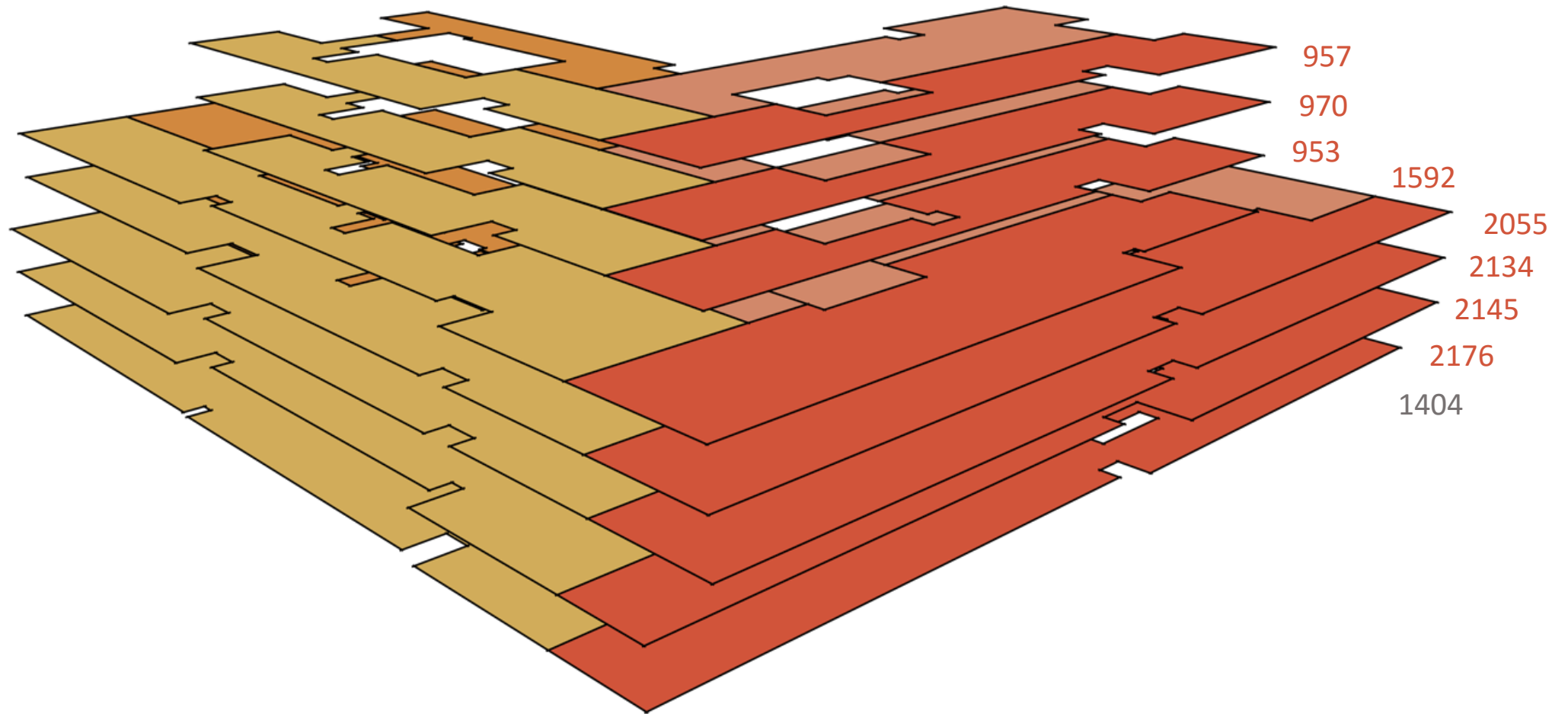

# Model organization

- Radiance model structure

- Generation of blinds operation schedules per spatial zone:

- North-East Zone
- North-West Zone
- South-East Zone
- South-West Zone

691 window groups

Direct solar simulations (1)

- Application of blinds schedule to entire floor plate:

- Whole floor

691 window groups

Ambient simulations per blind condition (2)

**Blinds operated result**

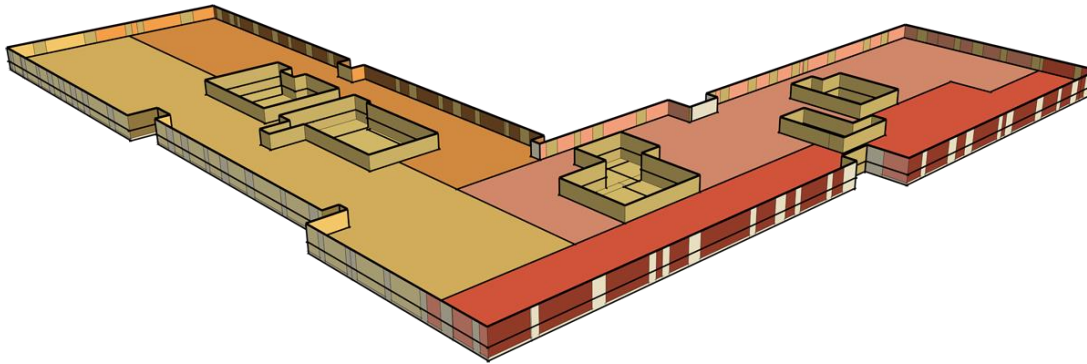



# Using RAD and OBJ geometry as processing tools

- Generating additional simulation elements using available geometry.
  - Wavefront .OBJ
  - Native .RAD

```
# obj2rad -f usb.obj
# Alias OBJ Model File
# Exported from SketchUp, (c) 2000-2012 Trimble Navigation Limited
# File units = meters
```

```
OpenStudio_Floor_Ext polygon Mesh1.Group1.Model.1
0
0
18
```

7.04808	64.0353	0.0381
32.7513	64.0353	0.0381
32.7513	50.2002	0.0381
-1.5283	50.2002	0.0381
-1.5283	56.7708	0.0381
0.375115	57.2217	0.0381

```
# Done processing file: usb.obj
# 24 lines, 20 statements, 1 unrecognized
```

```
# Alias OBJ Model File
# Exported from SketchUp, (c) 2000-2012 Trimble Navigation Limited
# File units = meters
```

```
mtllib EDITED_US Bank Sketchup 6th floor.mtl
```

```
g Mesh1 Group1 Model
```

```
usemtl OpenStudio_Floor_Ext
v 7.04808 64.0353 0.0381
vt -262.715 499.317
vn 0 0 -1
v 32.7513 64.0353 0.0381
vt -1274.65 499.317
v 32.7513 50.2002 0.0381
vt -1274.65 -45.375
v -1.5283 50.2002 0.0381
vt 74.9375 -45.375
v -1.5283 56.7708 0.0381
vt 74.9375 213.313
v 0.375115 57.2217 0.0381
vt 0 231.063
f 1/1/1 2/2/1 3/3/1 4/4/1 5/5/1 6/6/1
```



Leverage the R  
statistical analysis  
software to generate  
assets for Radiance  
simulation.

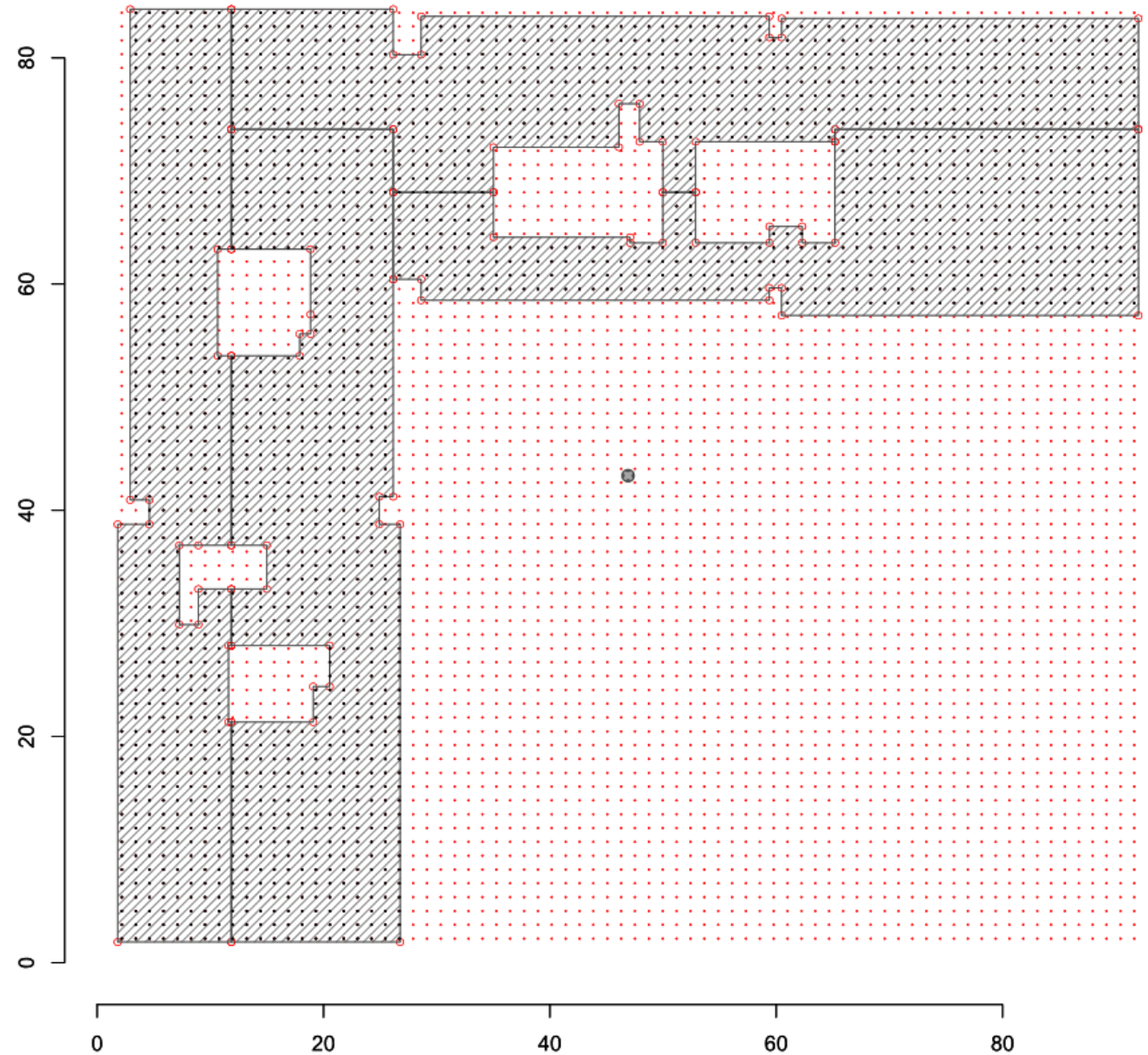

# Radiance three-phase

$$\begin{matrix}
 \begin{pmatrix} 1,1 \dots 1,145 \\ \vdots \\ n,1 \dots n,145 \end{pmatrix} & 
 \begin{pmatrix} 1,1 \dots 1,145 \\ \vdots \\ 145,1 \dots 145,145 \end{pmatrix} & 
 \begin{pmatrix} 1,1 \dots 1,2306 \\ \vdots \\ 145,1 \dots 145,2306 \end{pmatrix} & 
 \begin{pmatrix} 1 \\ \vdots \\ 2306 \end{pmatrix} \\
 \mathbf{V} & \mathbf{T} & \mathbf{D} & \mathbf{S} \\
 (n \times 145) & (145 \times 145) & (145 \times 146/578/2306) & (146/578/2306 \times 1) \\
 \text{view matrix} & \text{trans. matrix (bsdf)} & \text{daylight matrix} & \text{weather data}
 \end{matrix}$$

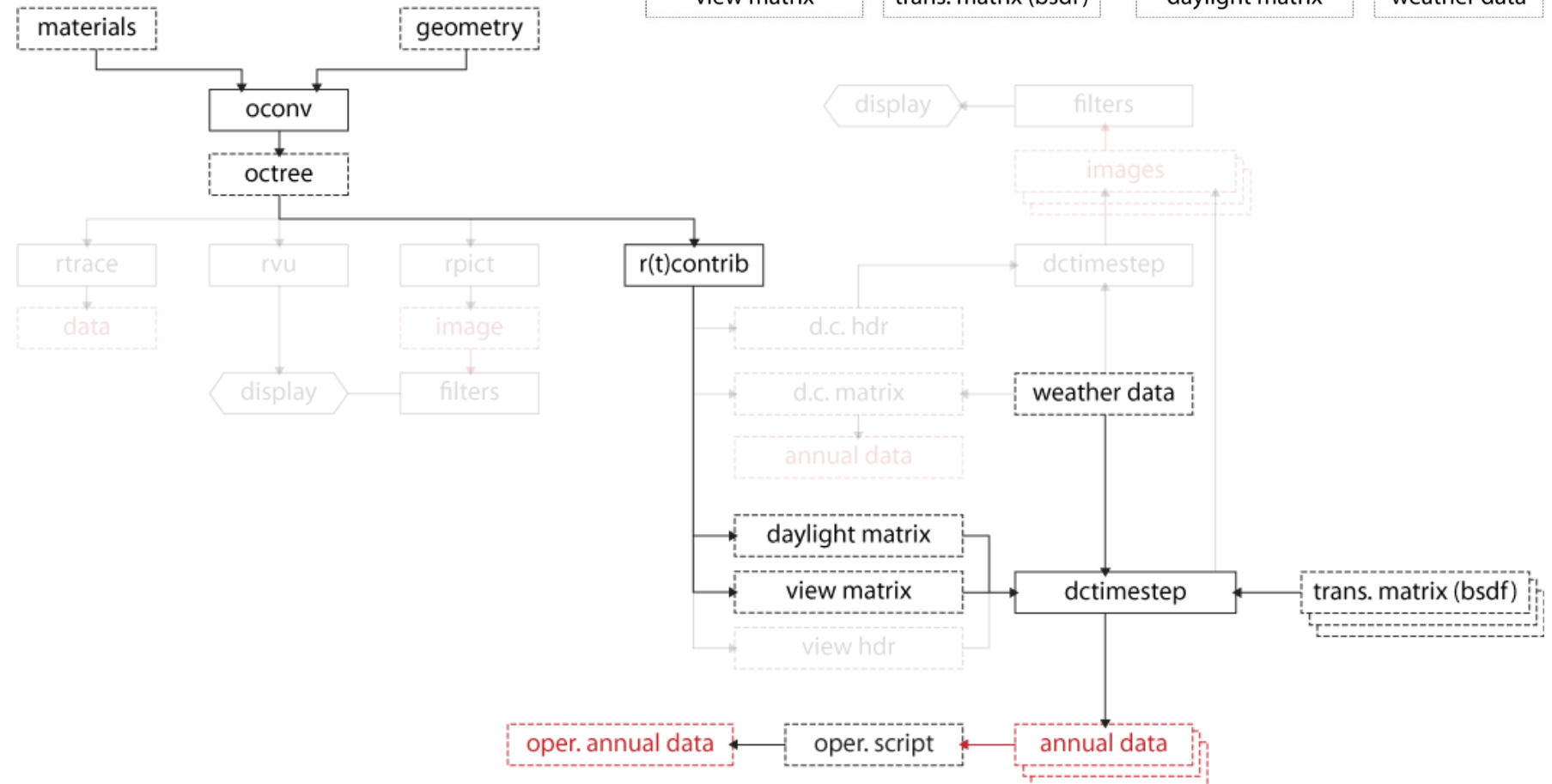

## Adapting Lutron's automated Quantum operation logic.

- Operates under three primary conditions, with an optional fourth.
- Photosensor-based control
  - Single 60-degree FOV vertical illuminance sensor centered horizontally, 25% from the window head.
  - Two 30-degree FOV vertical illuminance to be placed on opposite sides of a vertical mullion piece, effectively giving a 60-degree FOV.
- Condition 1
  - “Darkness Threshold” – If the sensor sees less than this level, shades attached to it are fully open/retracted.
- Condition 2
  - “Brightness Threshold” – If the sensor sees more than this level, shades attached to it are fully closed/deployed.
- Condition 3
  - If conditions 1 and 2 are not triggered, the penetration depth is calculated based on the sun's position and if it should exceed the maximum allowed setting then the shades are systematically lowered until below the maximum allowed depth.
- Condition 4 (optional)
  - “Visor” – This sets the fully retracted shade height to a minimum level to help mitigate sky brightness.





## Horizontal Profile Angle

- Using horizontal and parallel profile angles to calculate solar penetration depth.

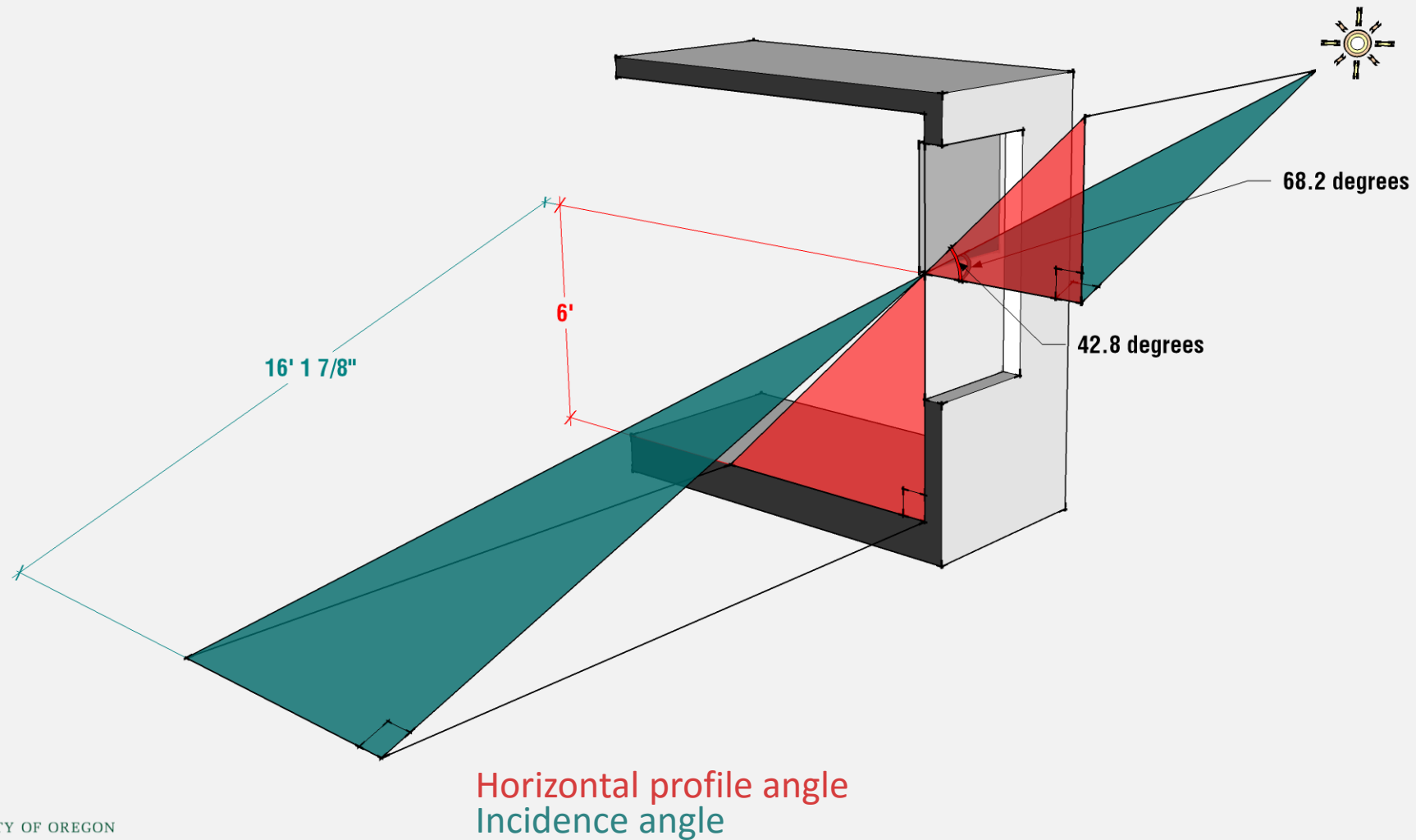

## Photo-sensor representation

- Sensor-based operation
- Captured field of view

```
#  
# Angle/view cut-off cones...  
#  
# Cone height/length: 0.1524 meters (6 inches)  
# Base/opening radius: 0.0889 meters (3.5 inches)  
# Apex radius: 0 meters (0 inches)  
# Resulting view angle: 62.28 degrees  
#  
# Generated for input: "2nd_sensors.pts"  
#  
  
void plastic black          0 0 5      0 0 0 0 0  
  
black cone cutoff.1  
0  
0  
8  
26.133921 75.817913 29.2481  
26.286575 75.817913 29.2481  
0 0.0889
```

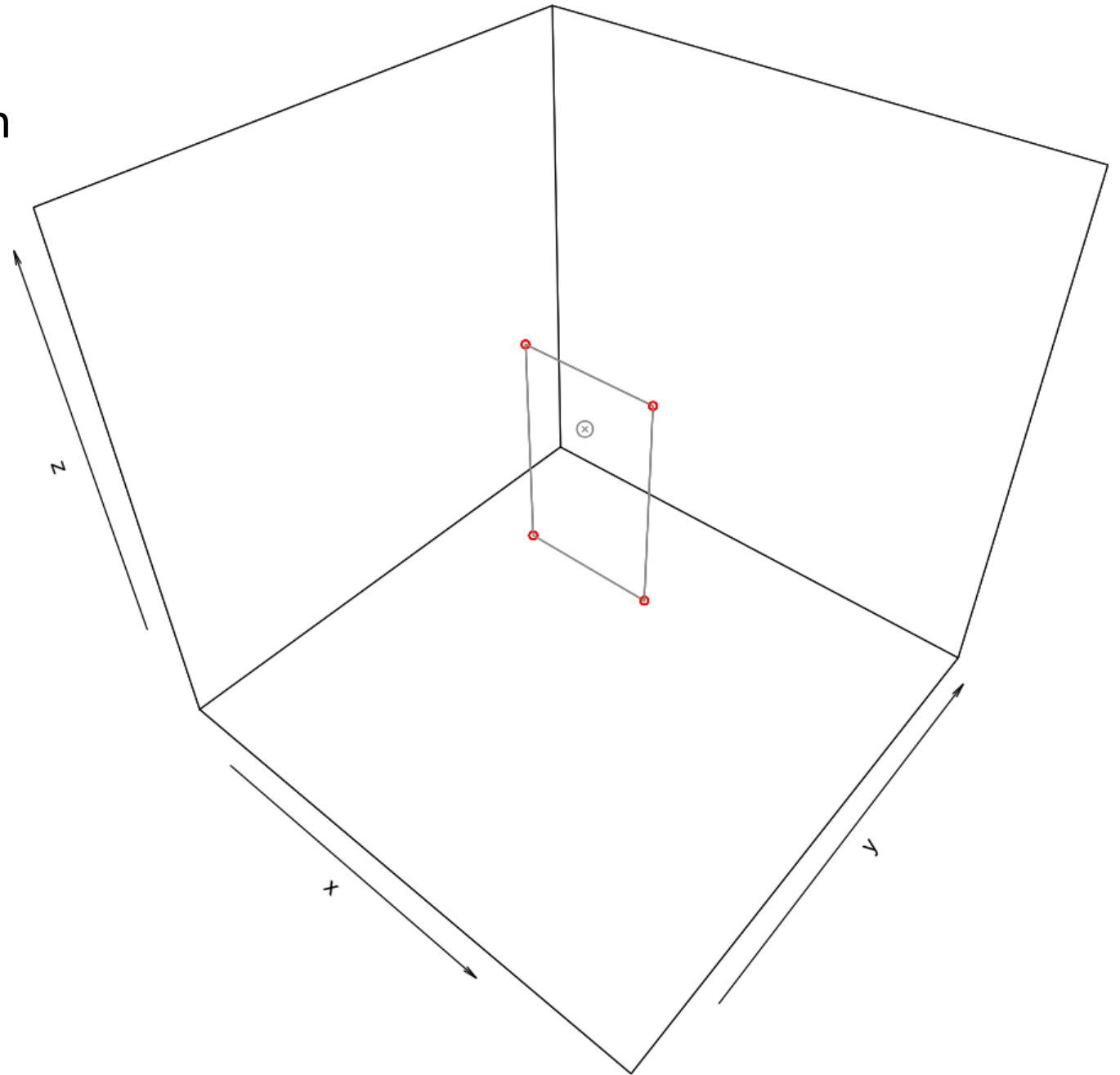
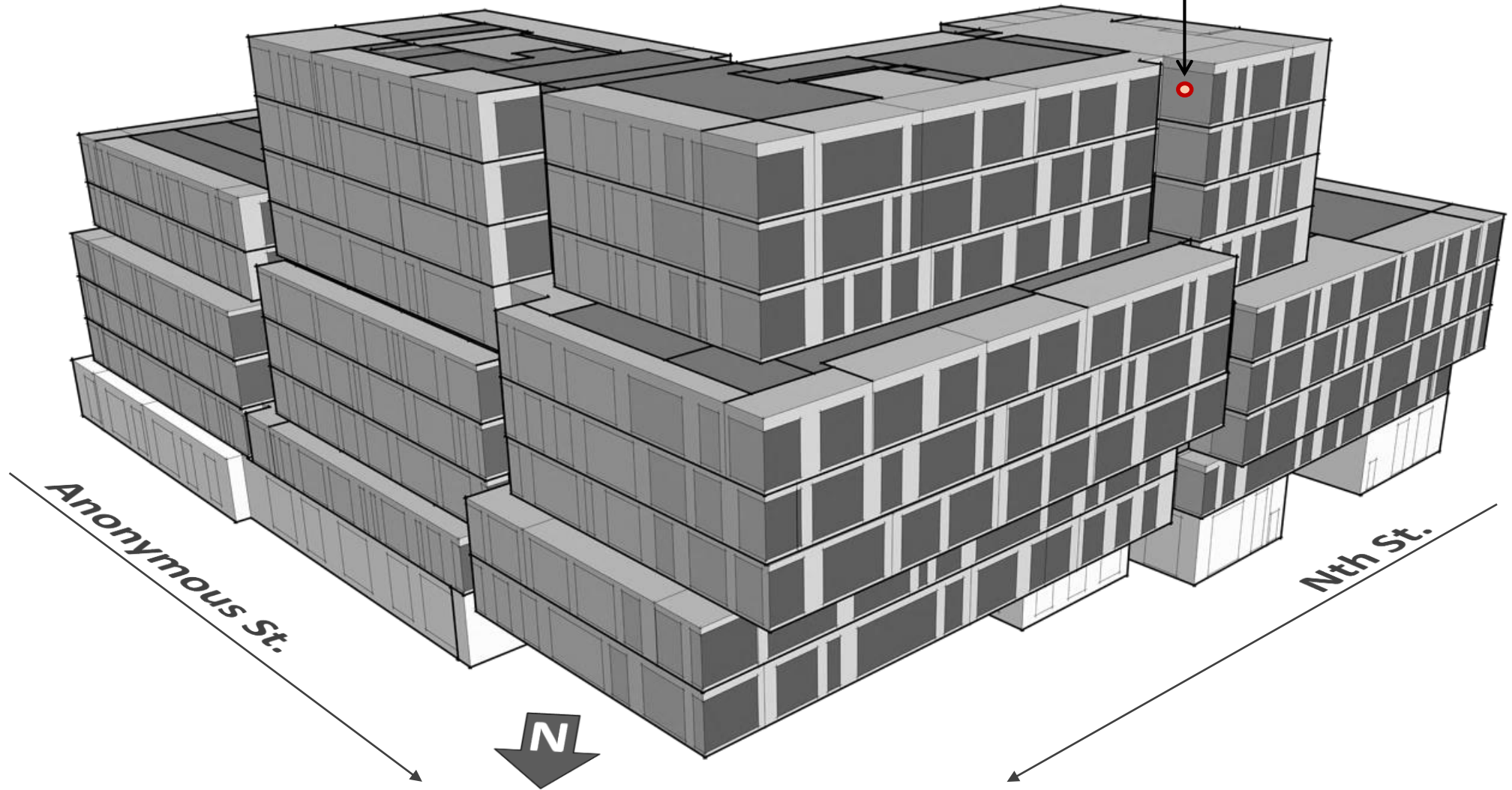
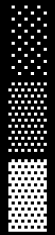

Photo-sensor representation



## Photo-sensor representation

- 180 degree FOV
- 400 Lux Darkness Threshold
- 5000 Lux Brightness Threshold
- 2.5 meter (8 ft.) penetration depth allowed
- 3+ shade/blind conditions



open (100%)

intermittent (interval)

closed (0%)

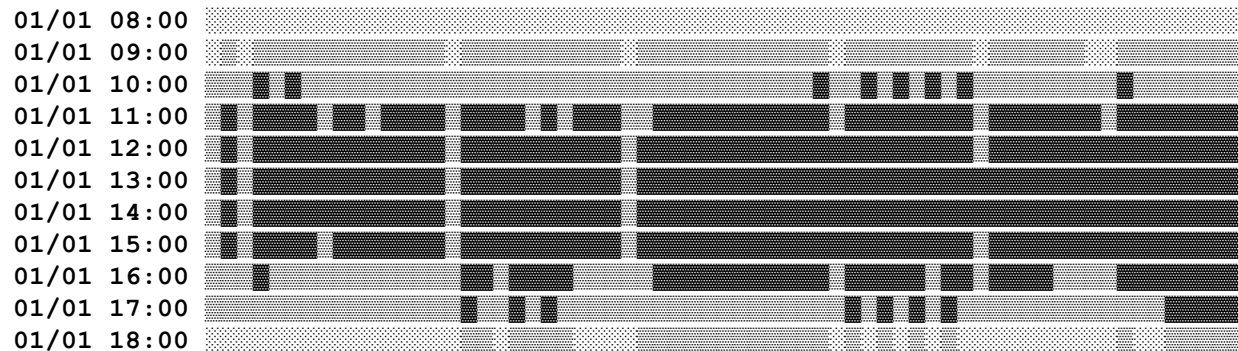



## Photo-sensor representation

- 180 degree FOV
- 500 Lux Darkness Threshold
- 6000 Lux Brightness Threshold
- 2.5 meter (8 ft.) penetration depth allowed
- 3+ shade/blind conditions

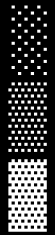

open (100%)

intermittent (interval)

closed (0%)

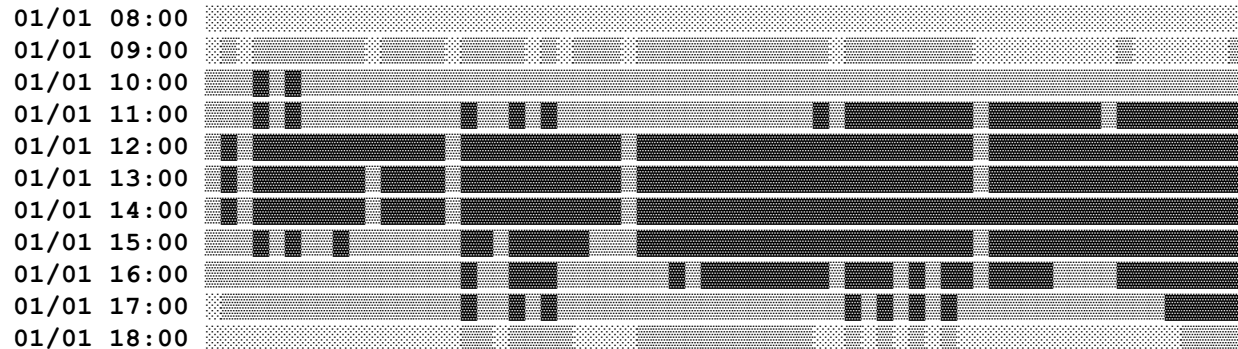

## Photo-sensor representation

- 60 degree FOV
- 500 Lux Darkness Threshold
- 6000 Lux Brightness Threshold
- 2.5 meter (8 ft.) penetration depth allowed
- 3+ shade/blind conditions

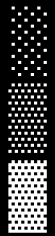

open (100%)

intermittent (interval)

closed (0%)

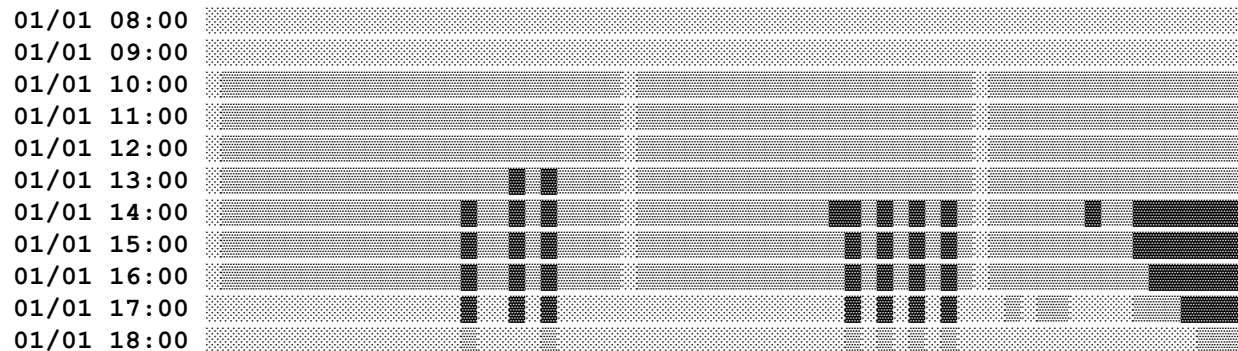
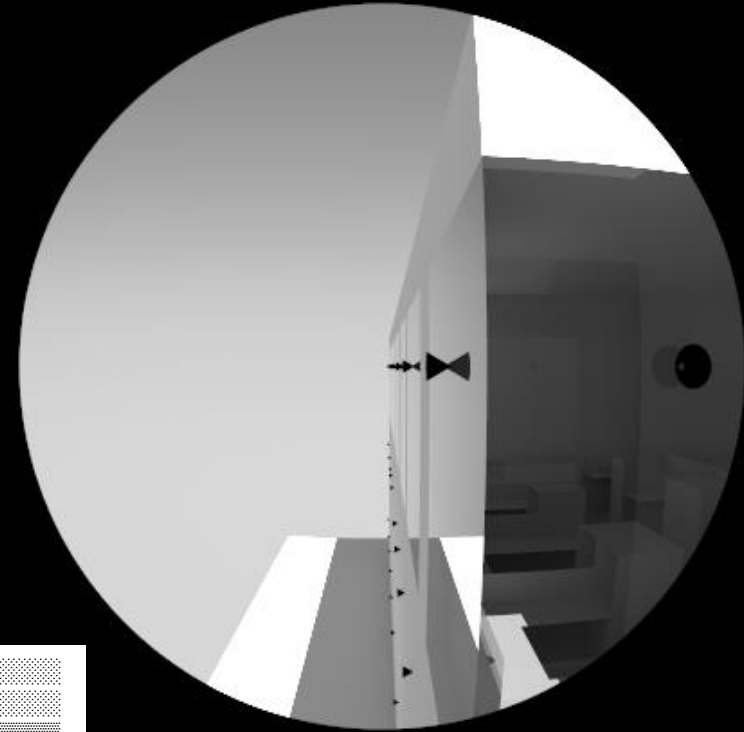

# Accounting for blind/shade height

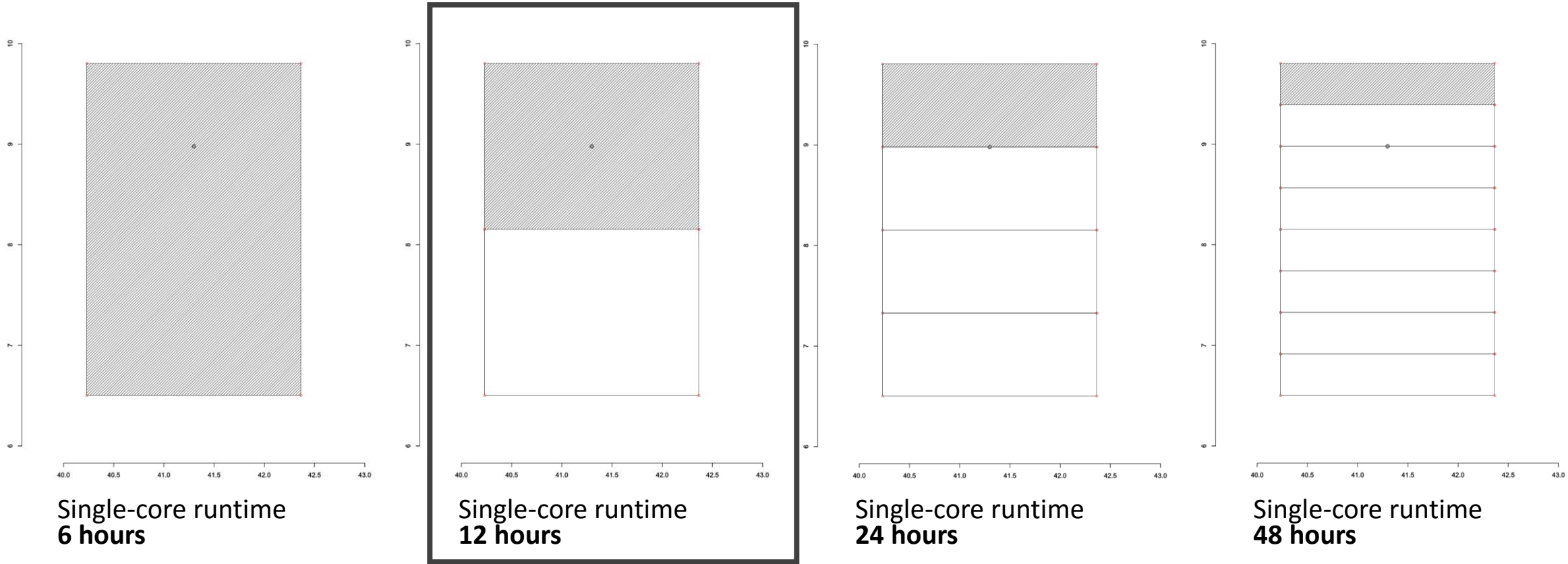

## Blinds operated results

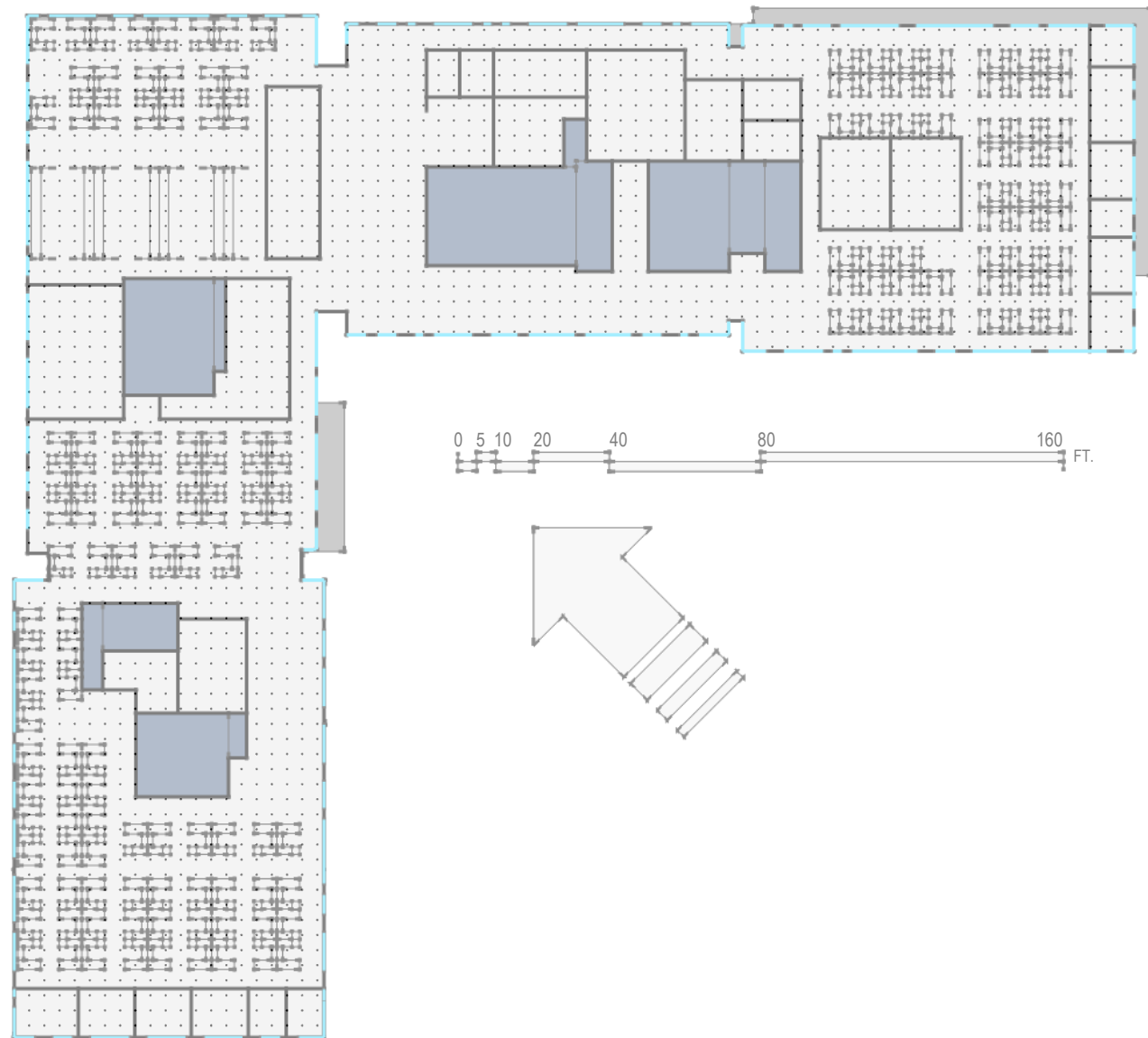



# Blinds operated results June 24<sup>th</sup>, 9:00



# Blinds operated results June 24<sup>th</sup>, 10:00

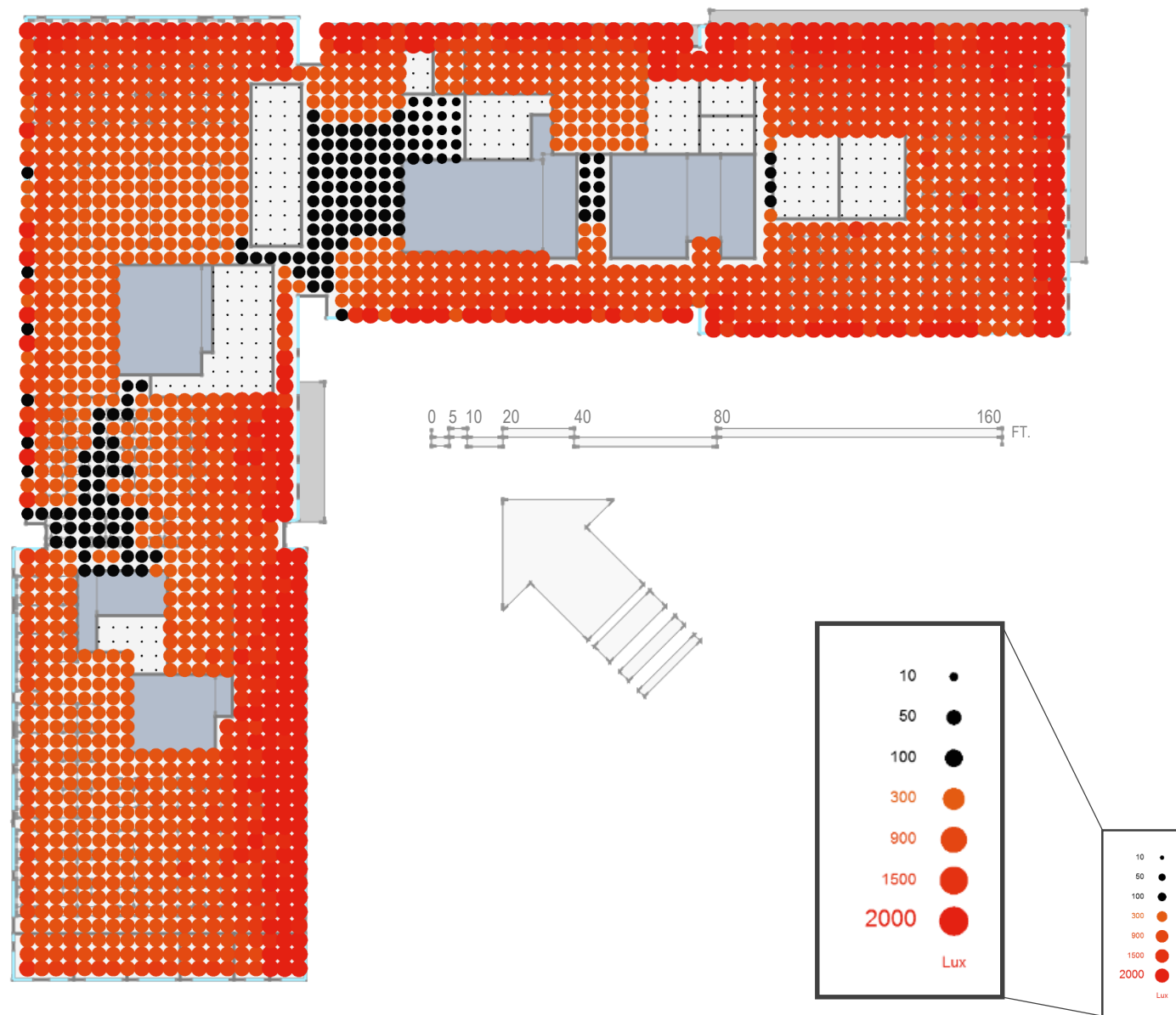

# Blinds operated results June 24<sup>th</sup>, 11:00

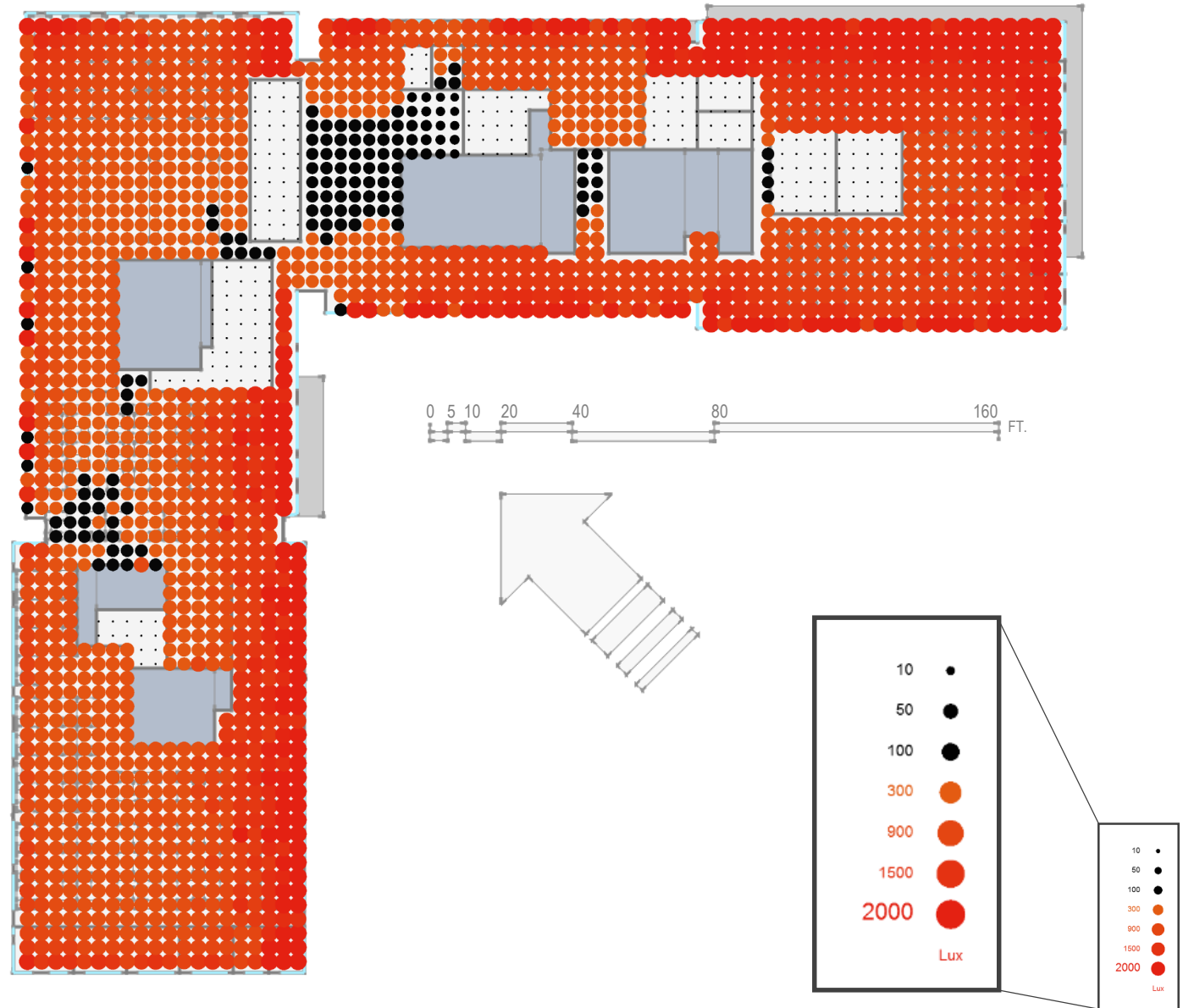

# Blinds operated results June 24<sup>th</sup>, 12:00

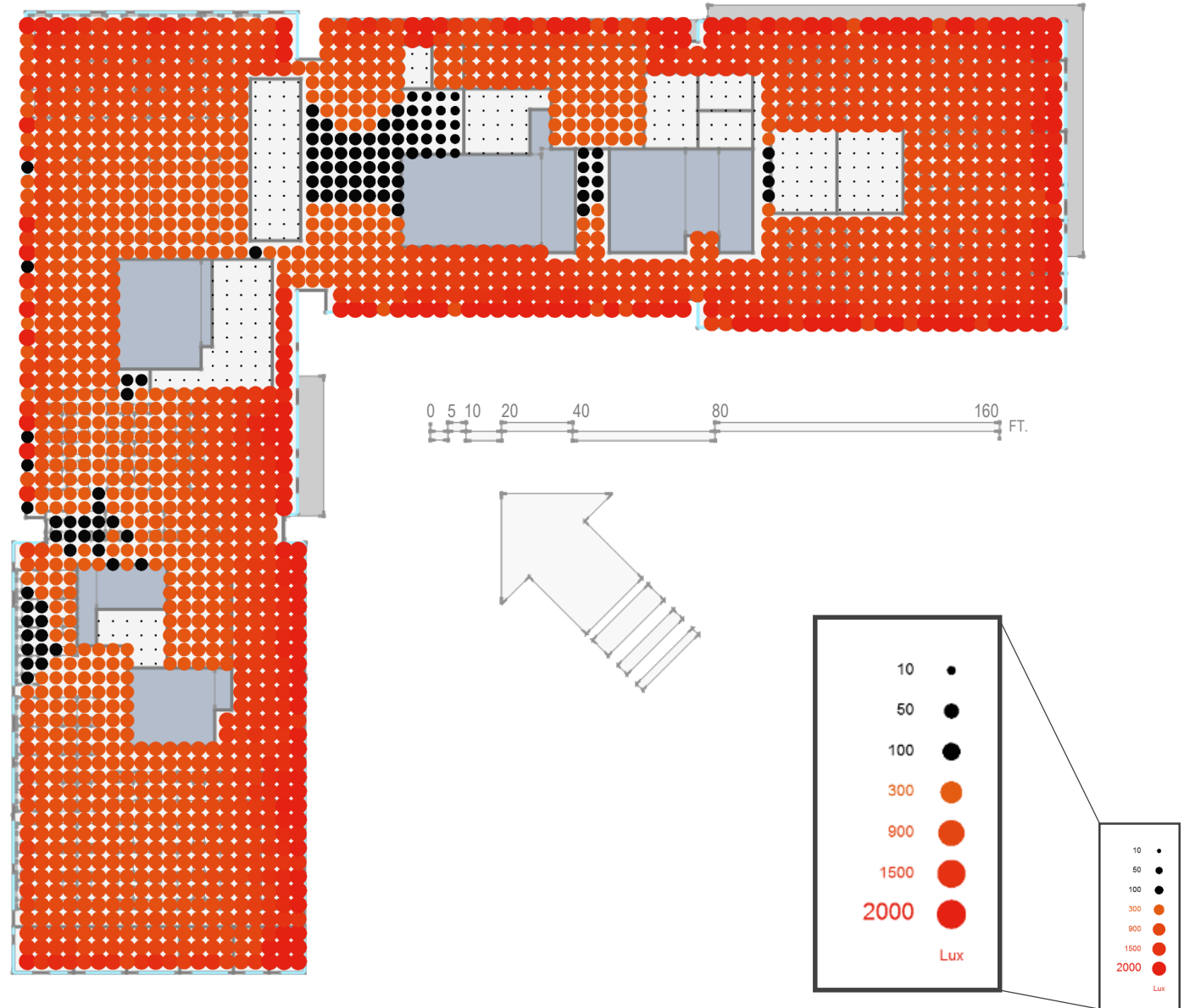

# Blinds operated results June 24<sup>th</sup>, 13:00

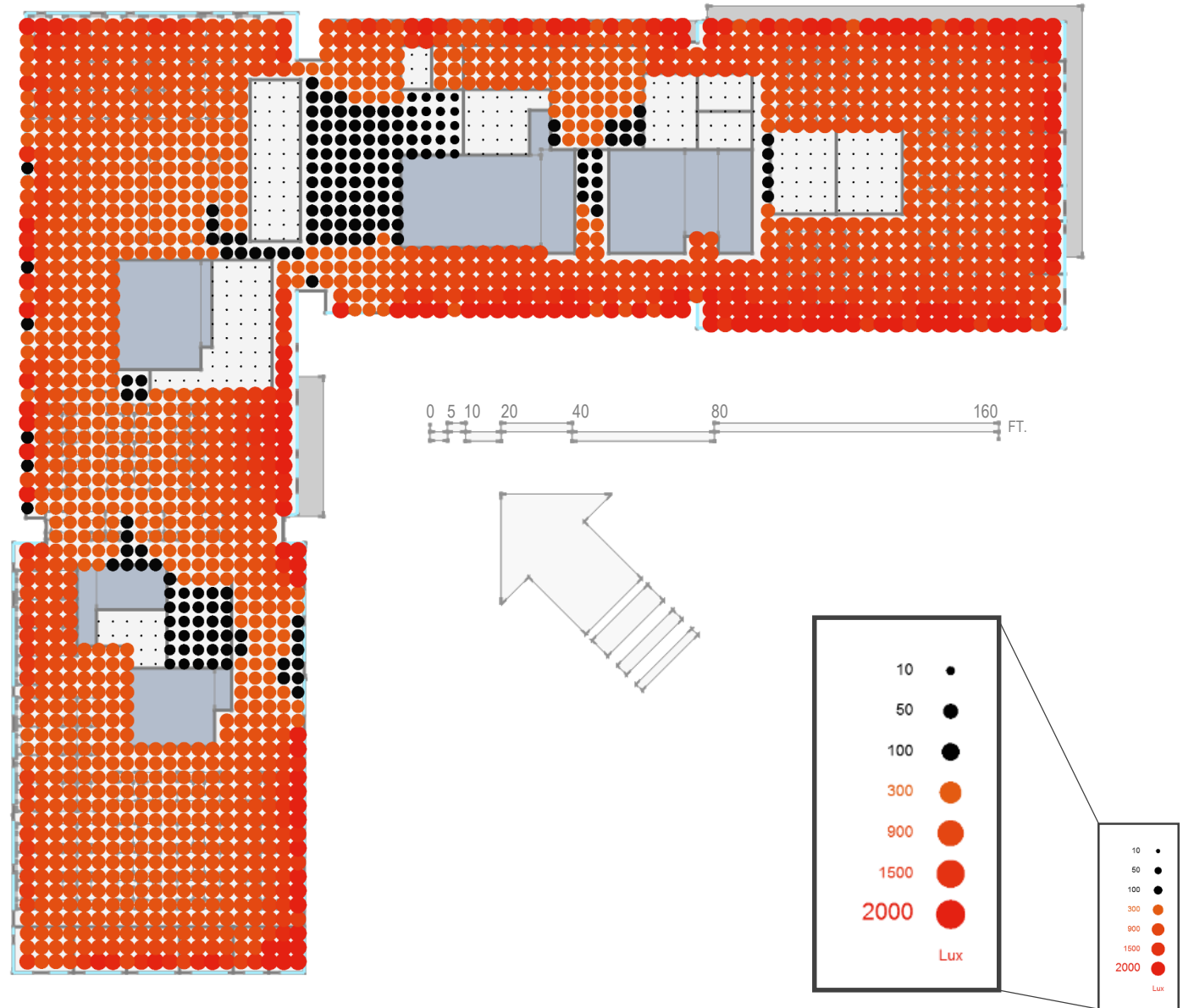

# Blinds operated results June 24<sup>th</sup>, 14:00

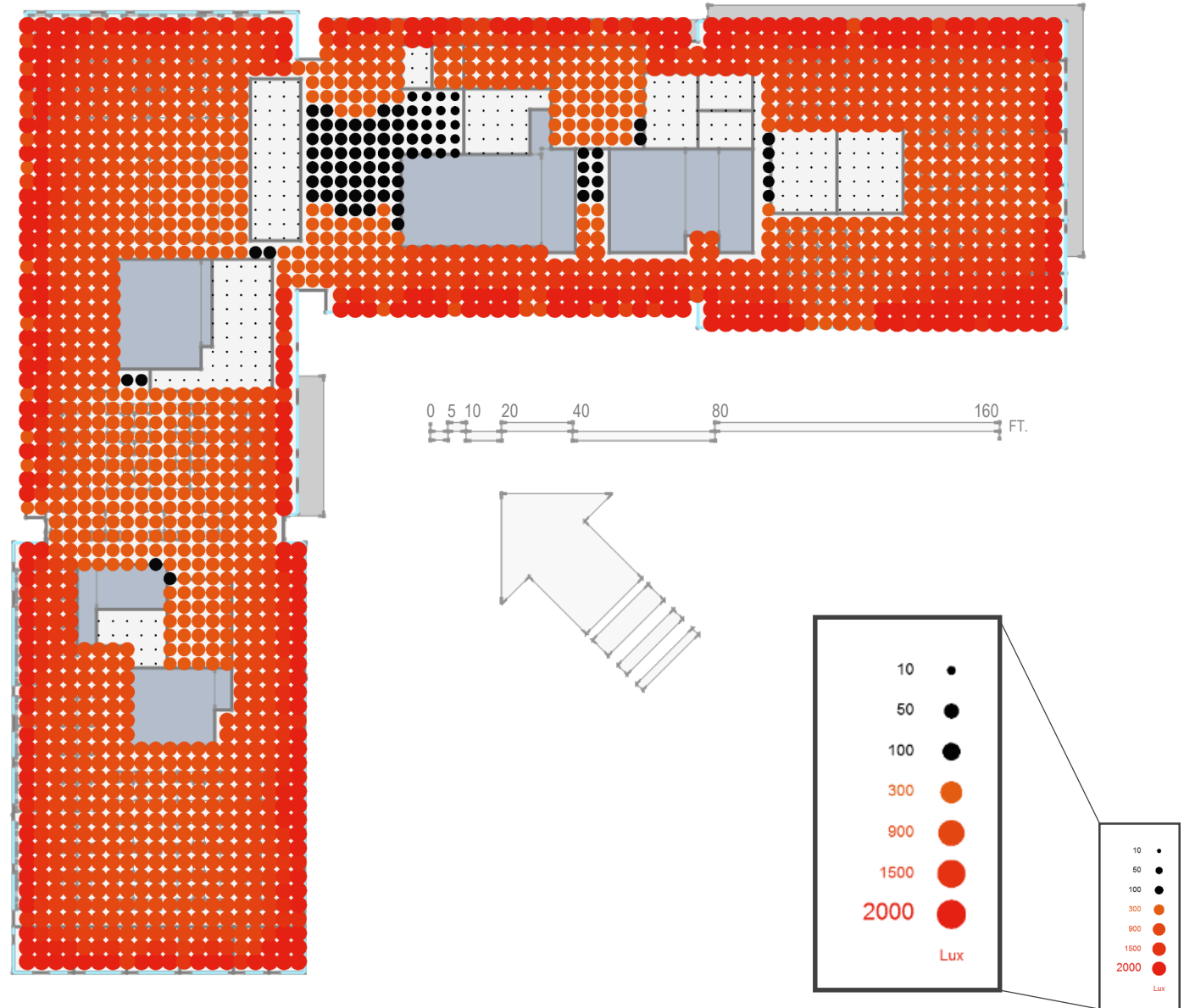



# Blinds operated results June 24<sup>th</sup>, 15:00

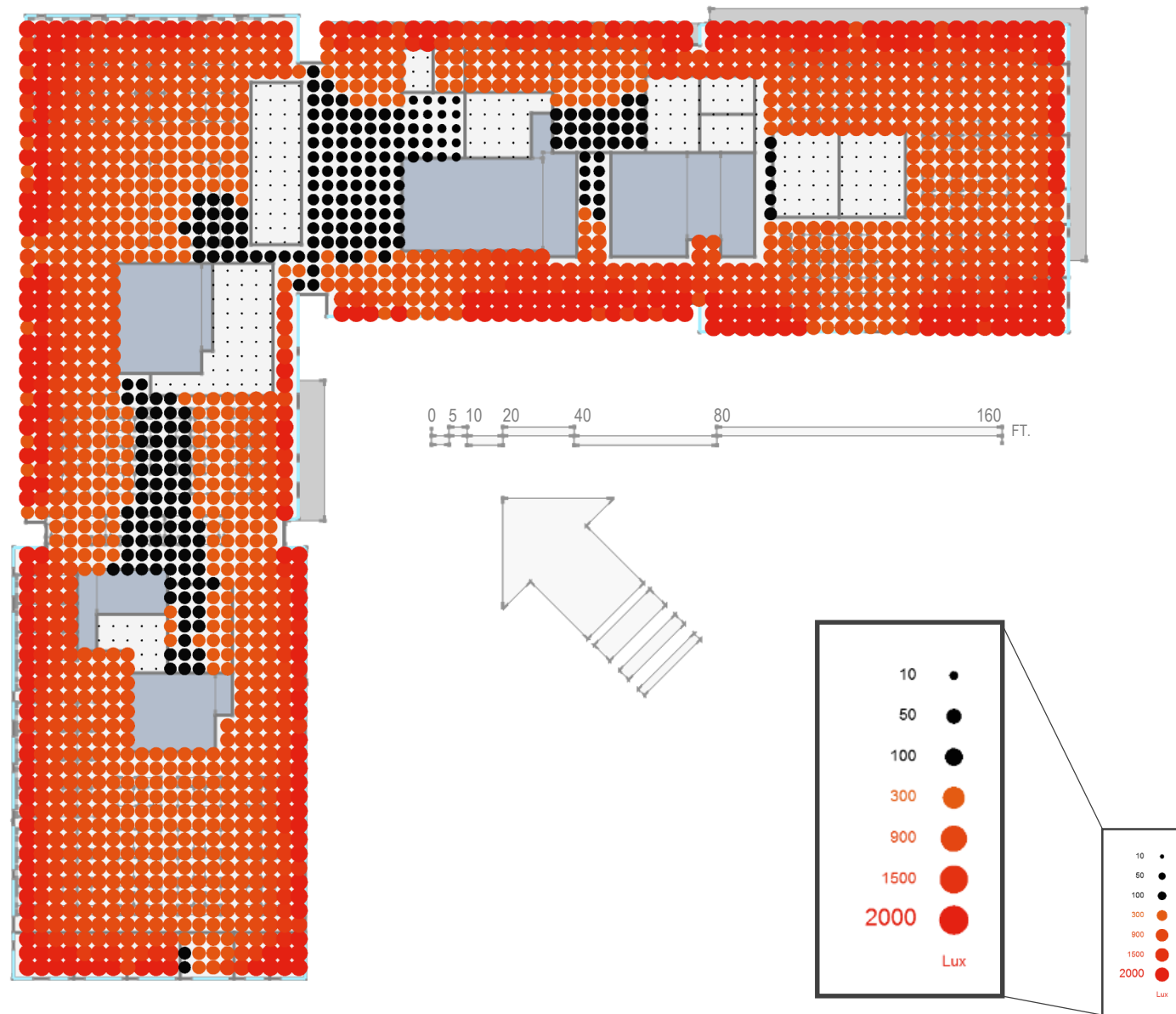

# Blinds operated results June 24<sup>th</sup>, 16:00

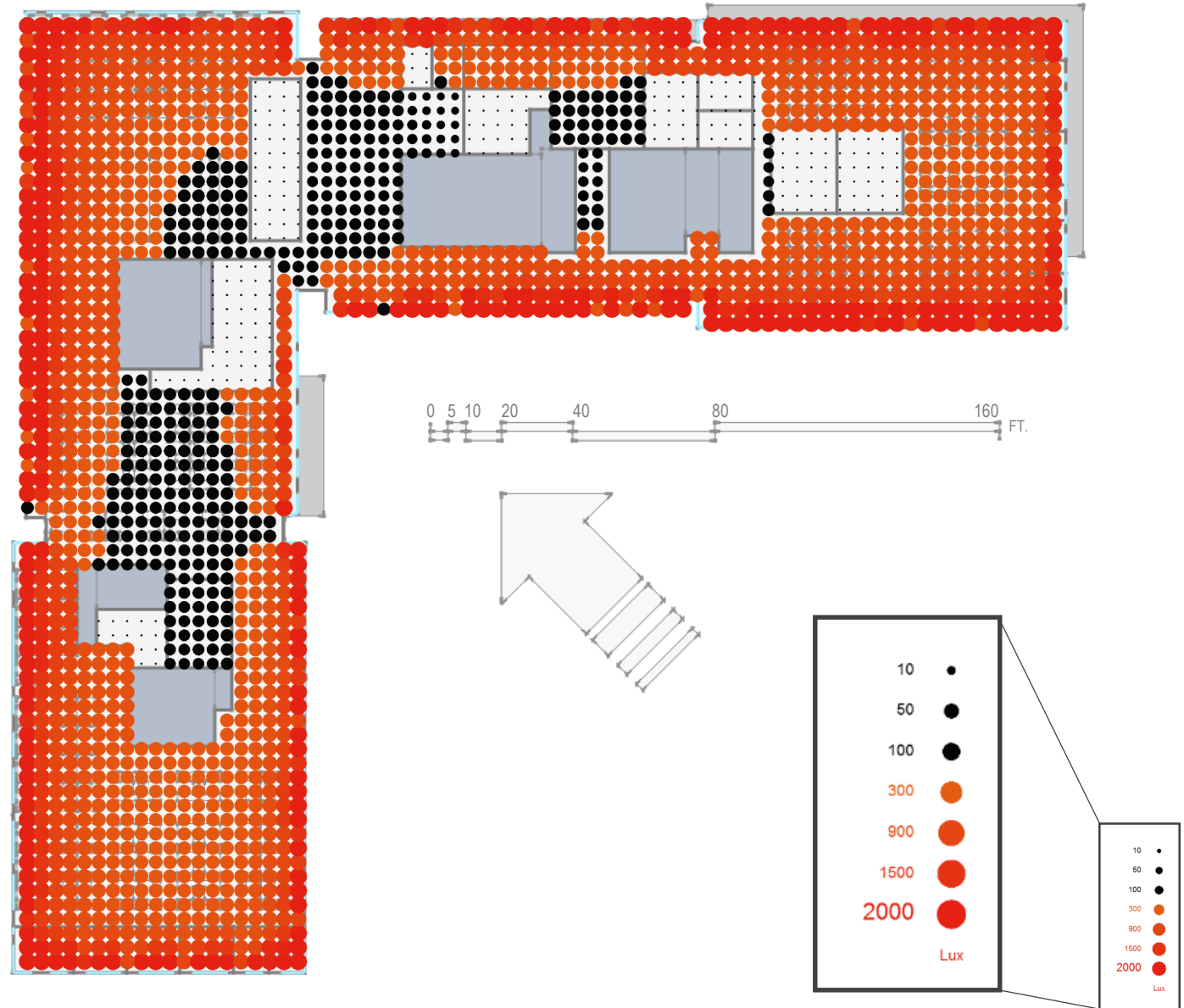

# Blinds operated results June 24<sup>th</sup>, 17:00

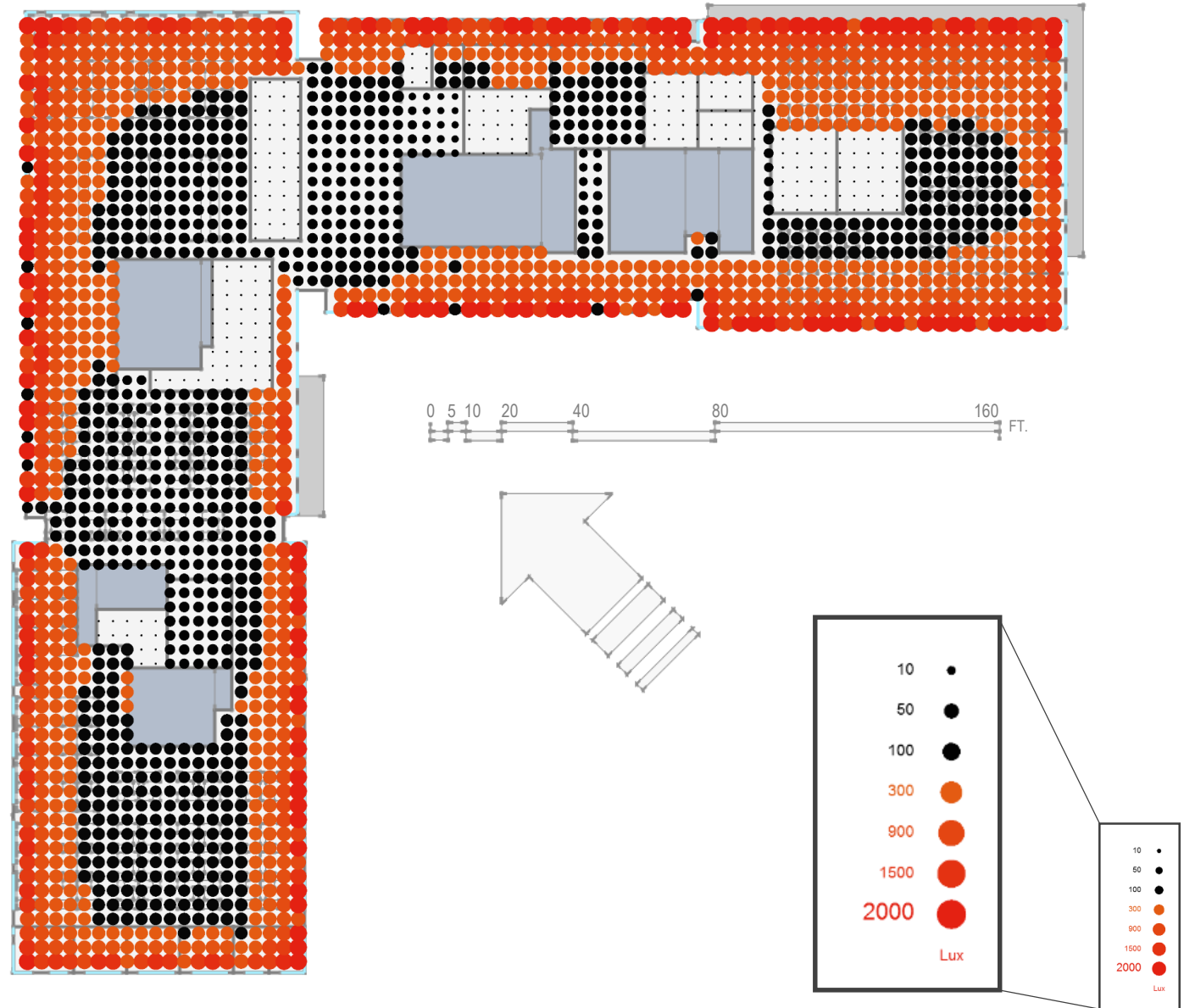

# Blinds operated results June 24<sup>th</sup>, 18:00

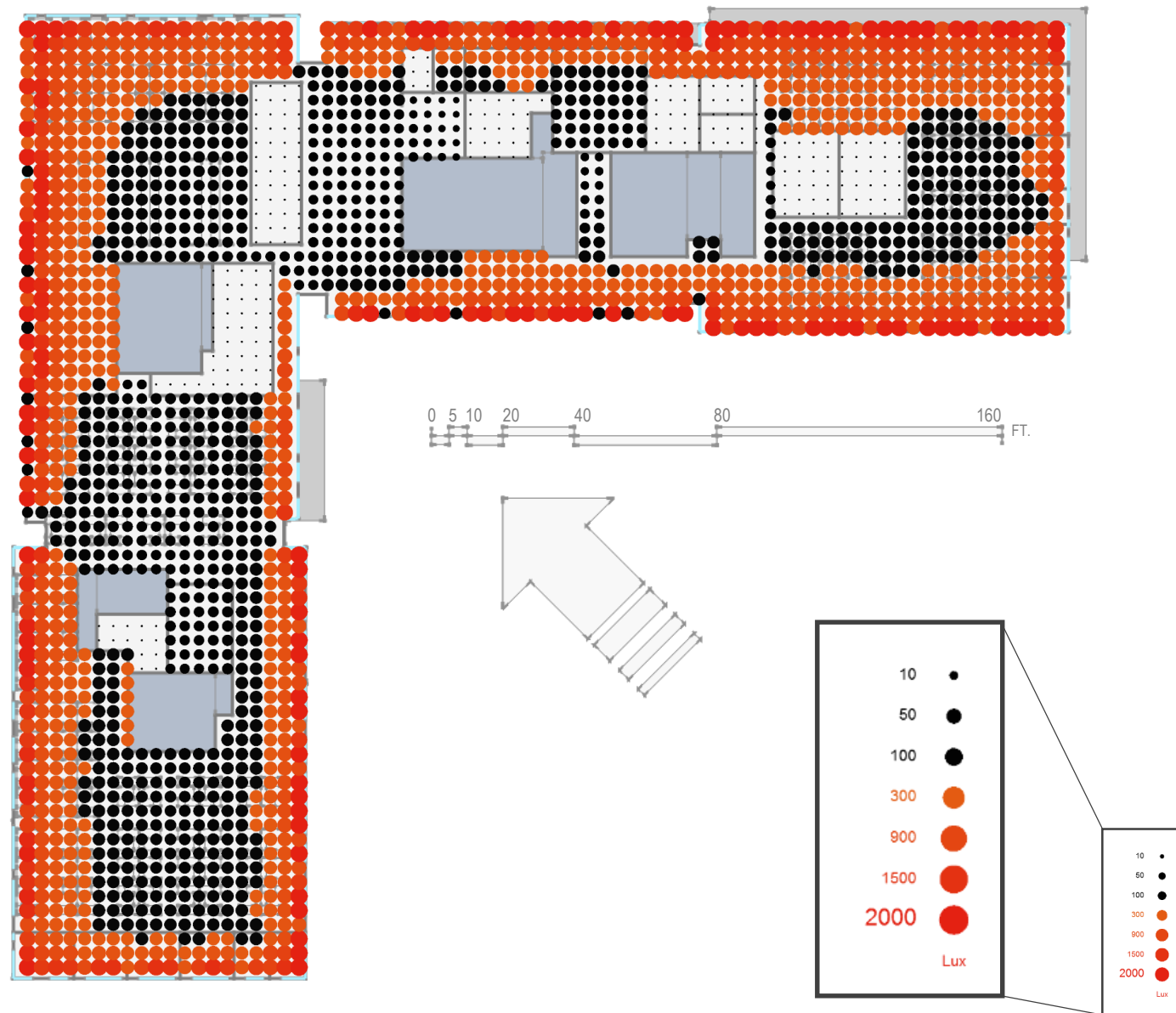

## Blinds operated results

- Spatial Daylight Autonomy

Floor	Zone	Time	DA(%)
2nd	all	Annual	73.2
3rd	all	Annual	80.4
4th	all	Annual	80.1
5th	all	Annual	71.3
6th	all	Annual	84.0
7th	all	Annual	72.9
8th	all	Annual	81.6
9th	all	Annual	88.3

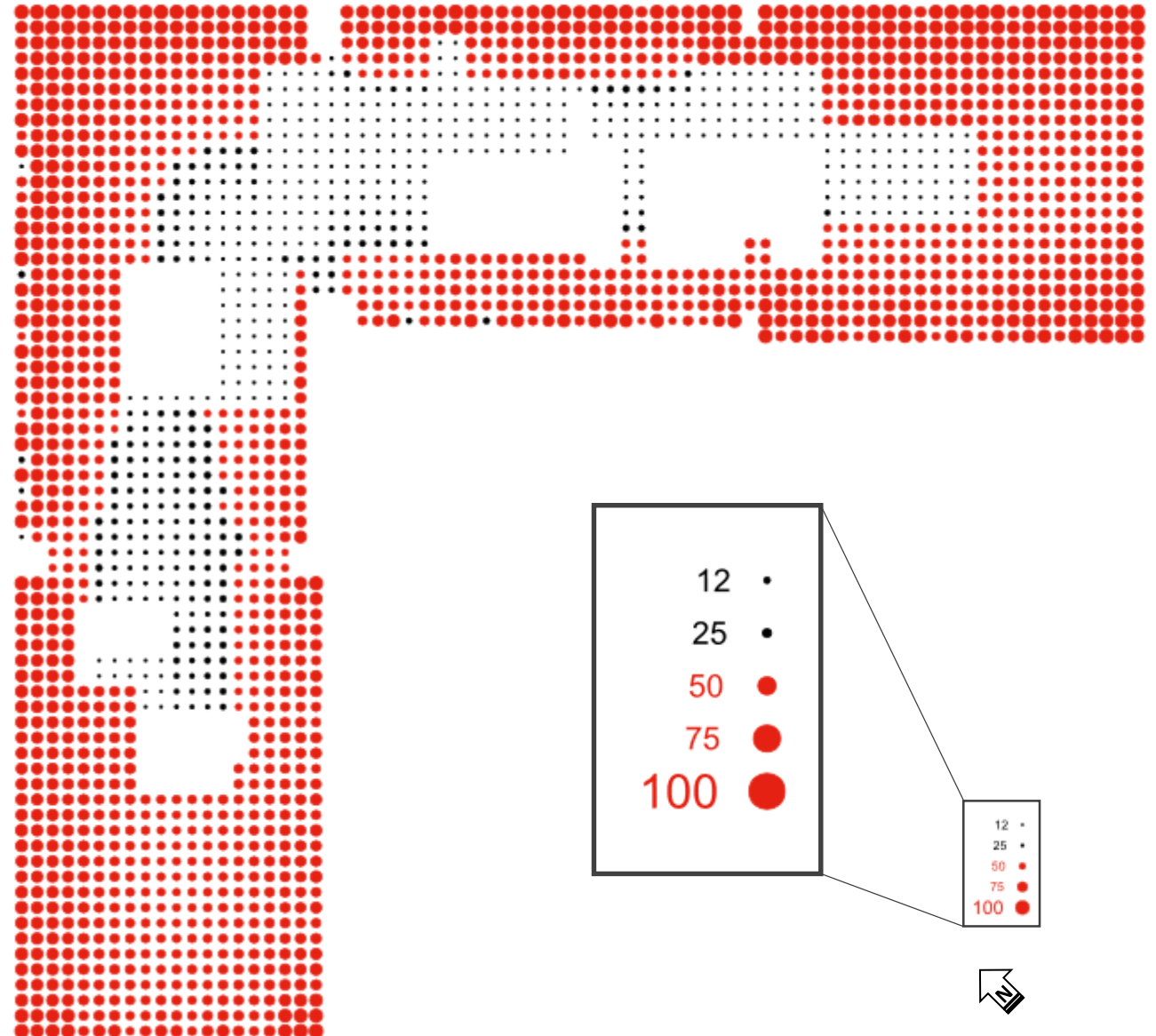

EnergyPlus and  
Radiance sharing  
geometry inputs.

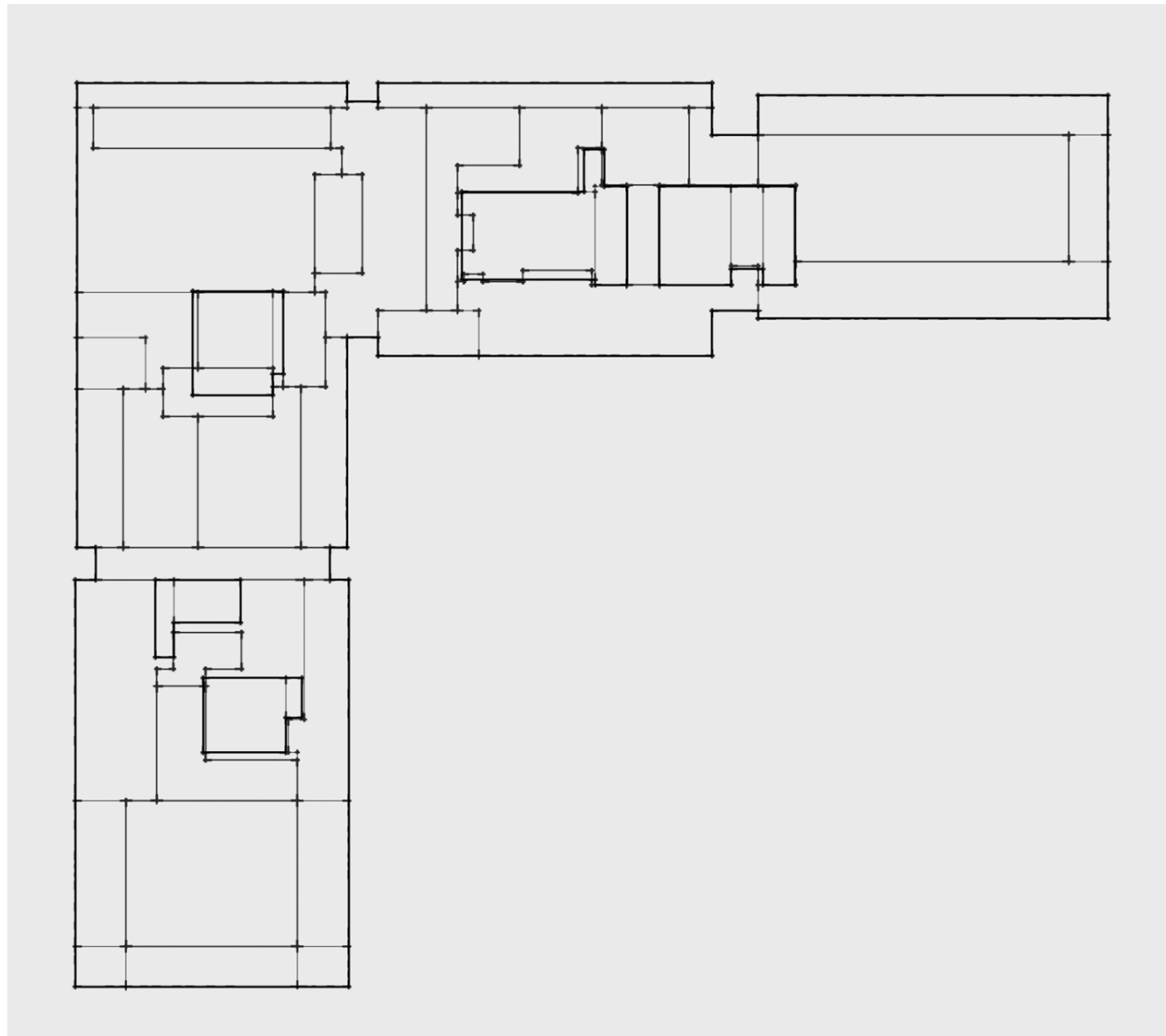



Overlaying of  
EnergyPlus thermal  
zones onto the  
Radiance analysis grid  
in order to isolate the  
points that are inside  
the zone.

These can be averaged,  
or a single point  
specified to generate  
the fractional lighting  
schedule.

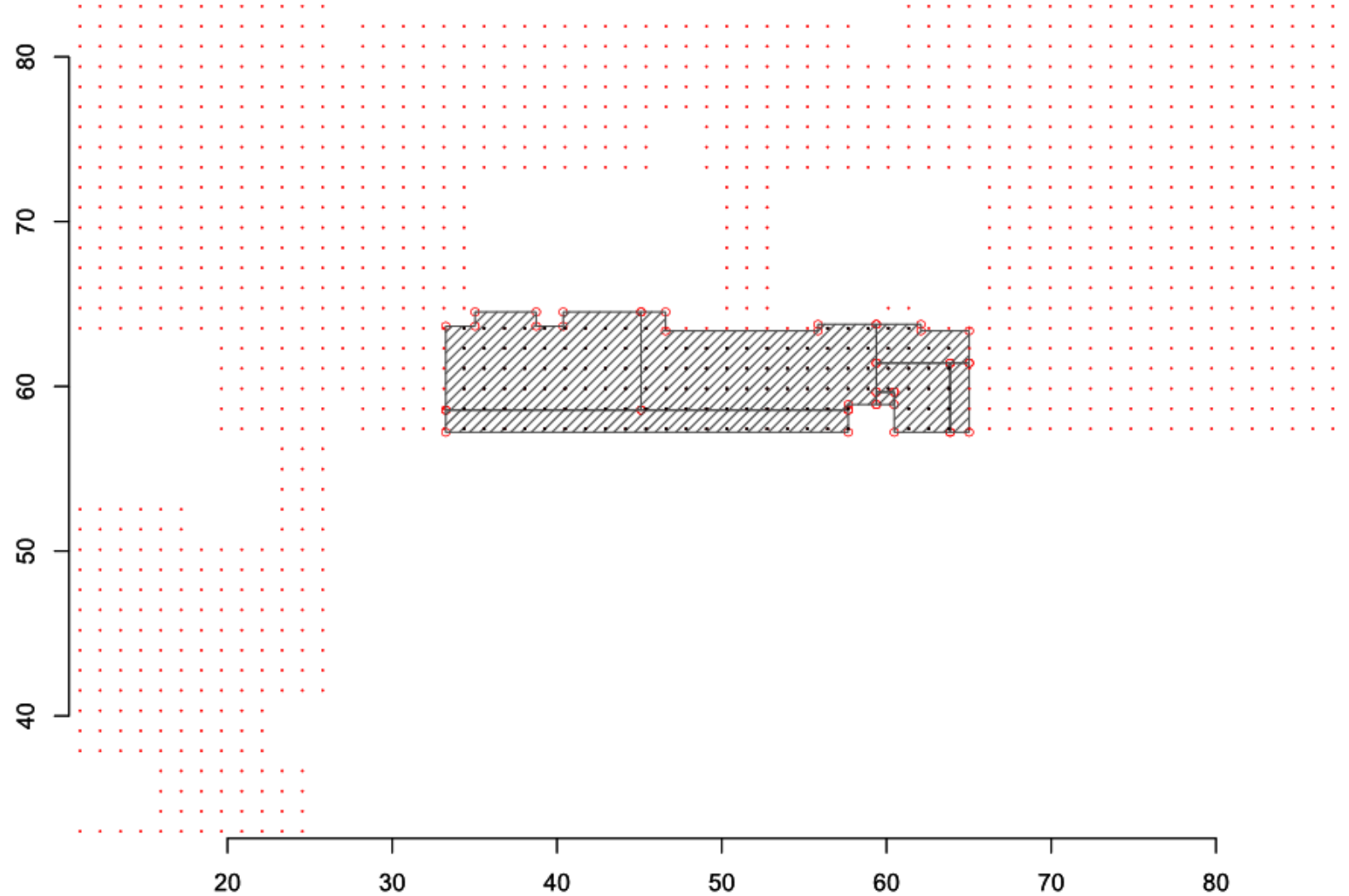

Energy end uses with 300 Lux level @ workplane

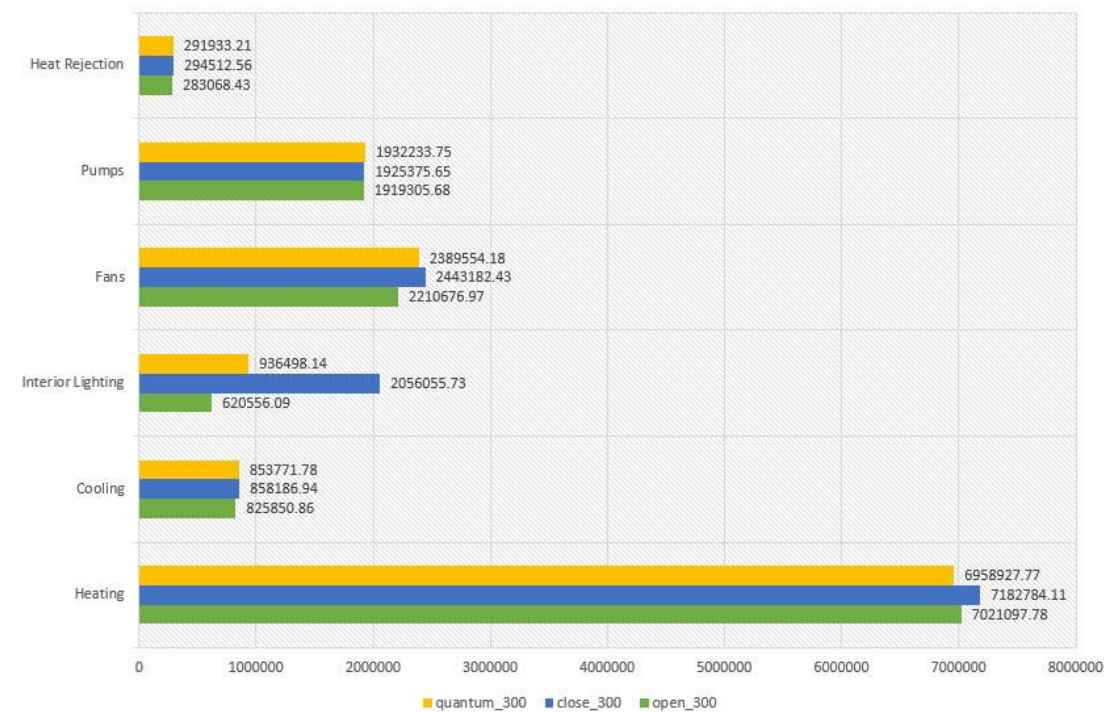

Energy end uses with 500 Lux level @ workplane

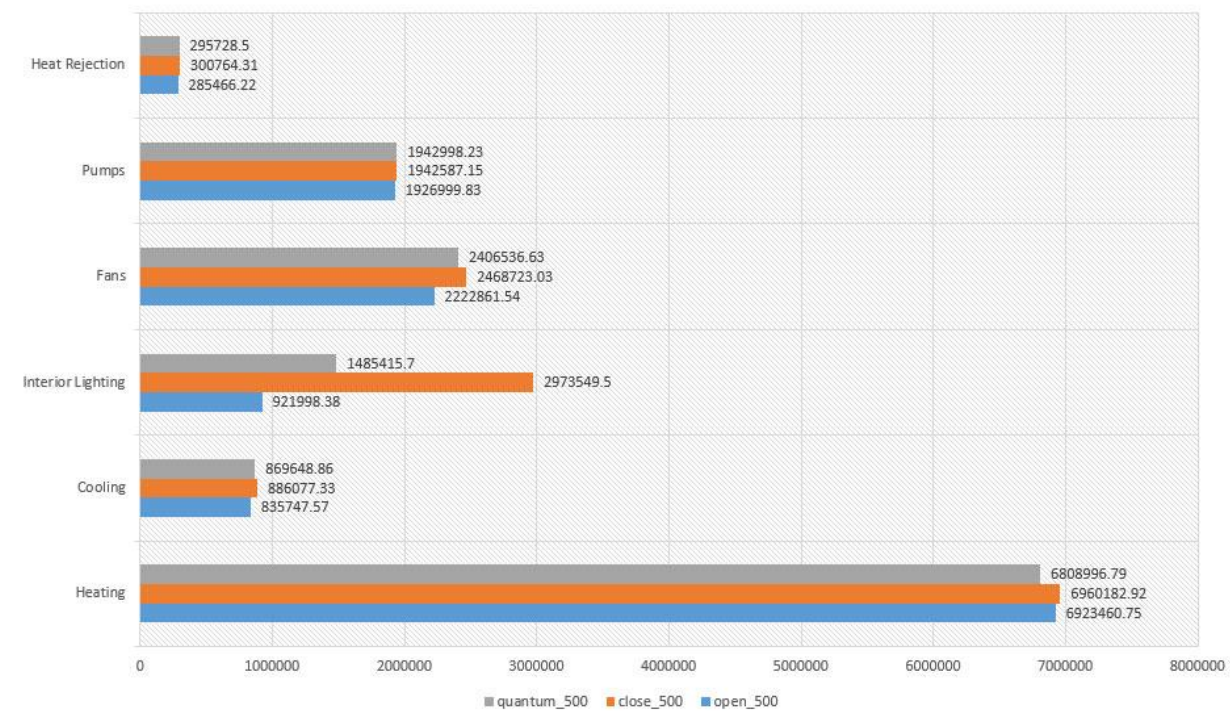

# Back to the blinds operation data

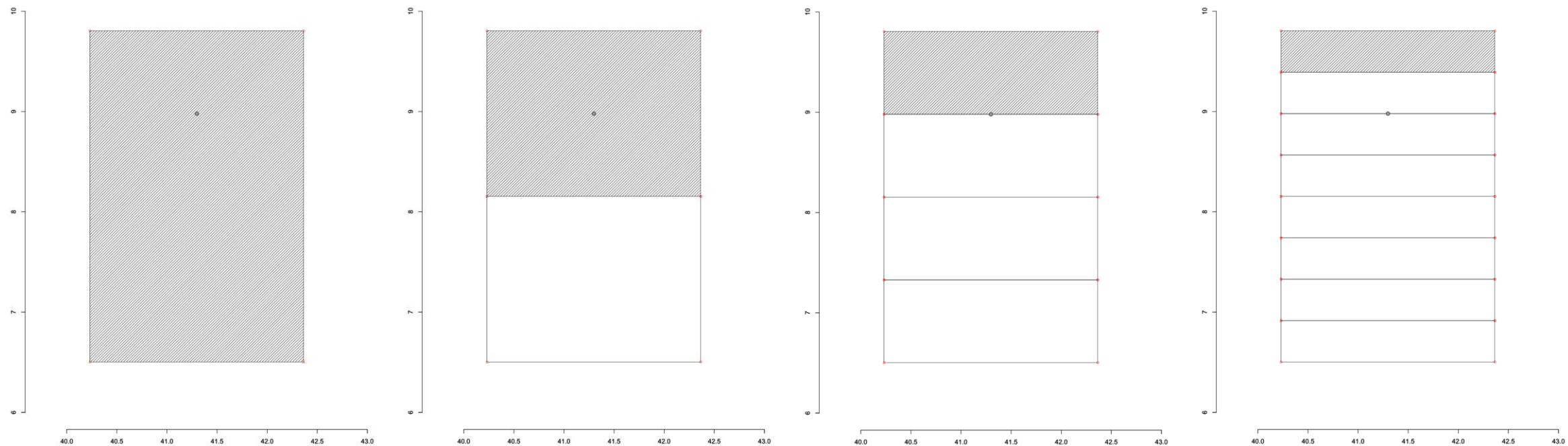

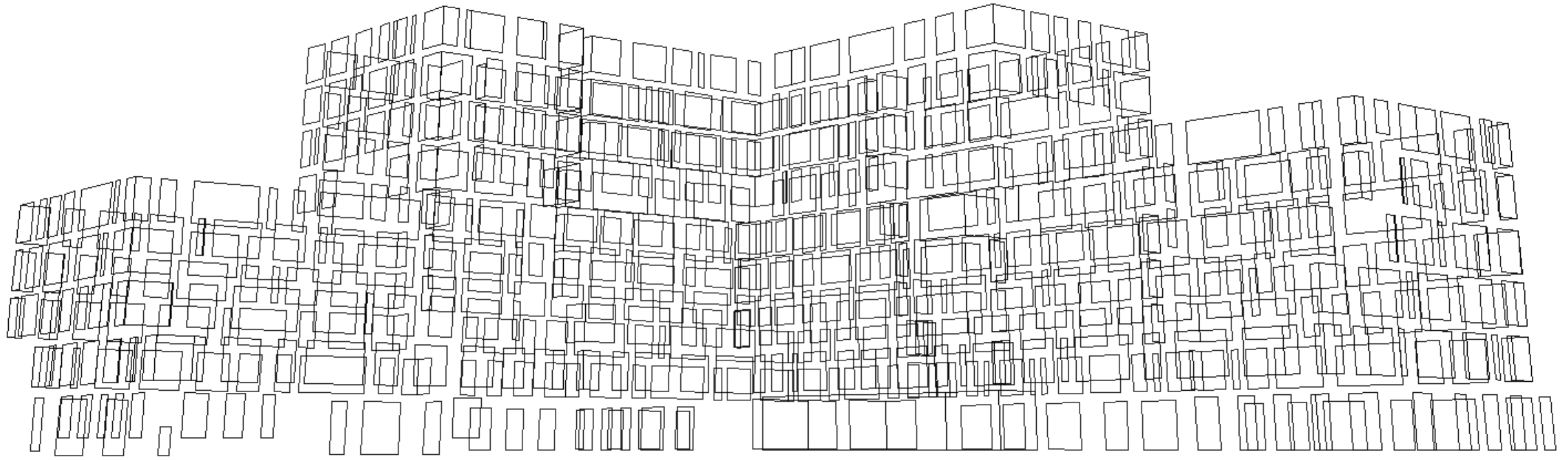

UNIVERSITY OF OREGON

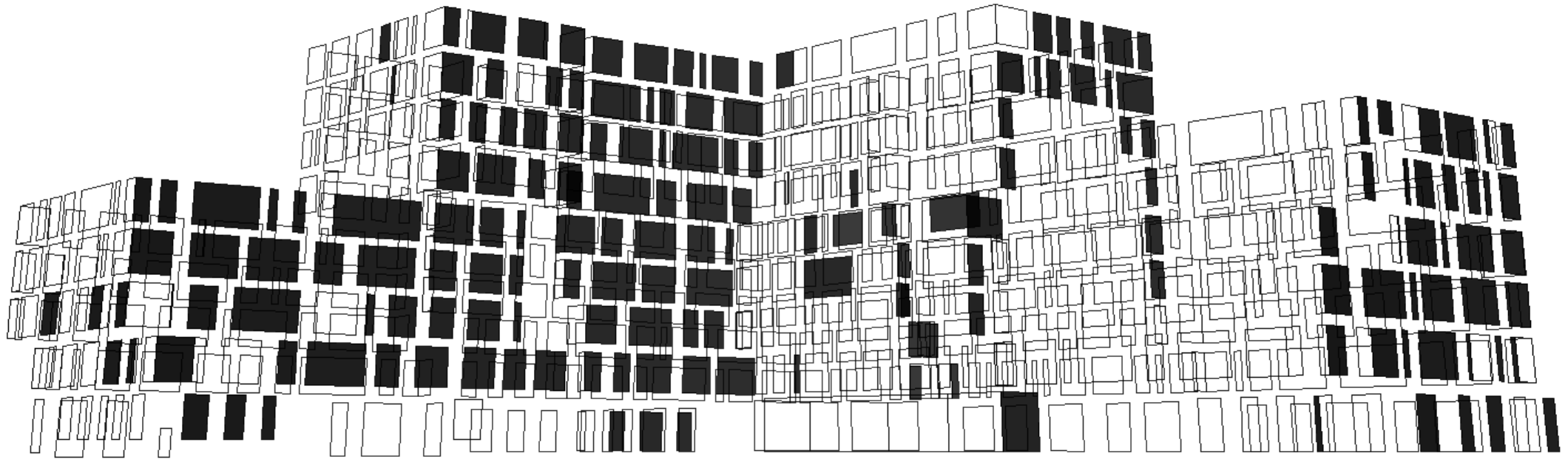

UNIVERSITY OF OREGON

06/24/2015 [43.6167, -116.2]

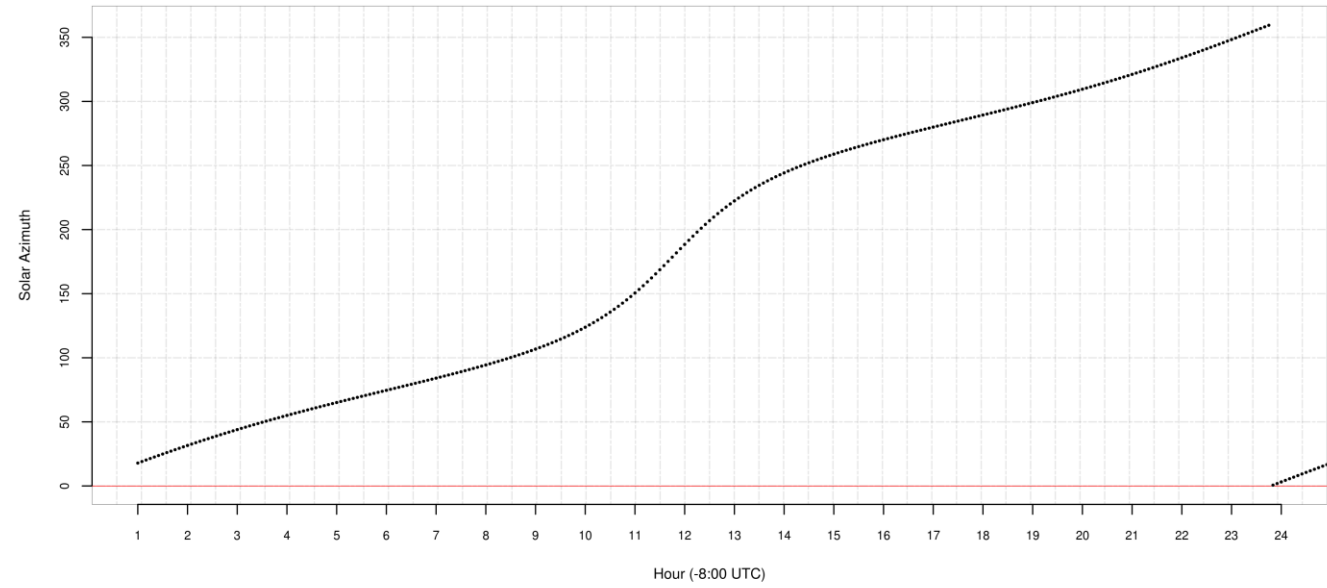

06/24/2015 [43.6167, -116.2]

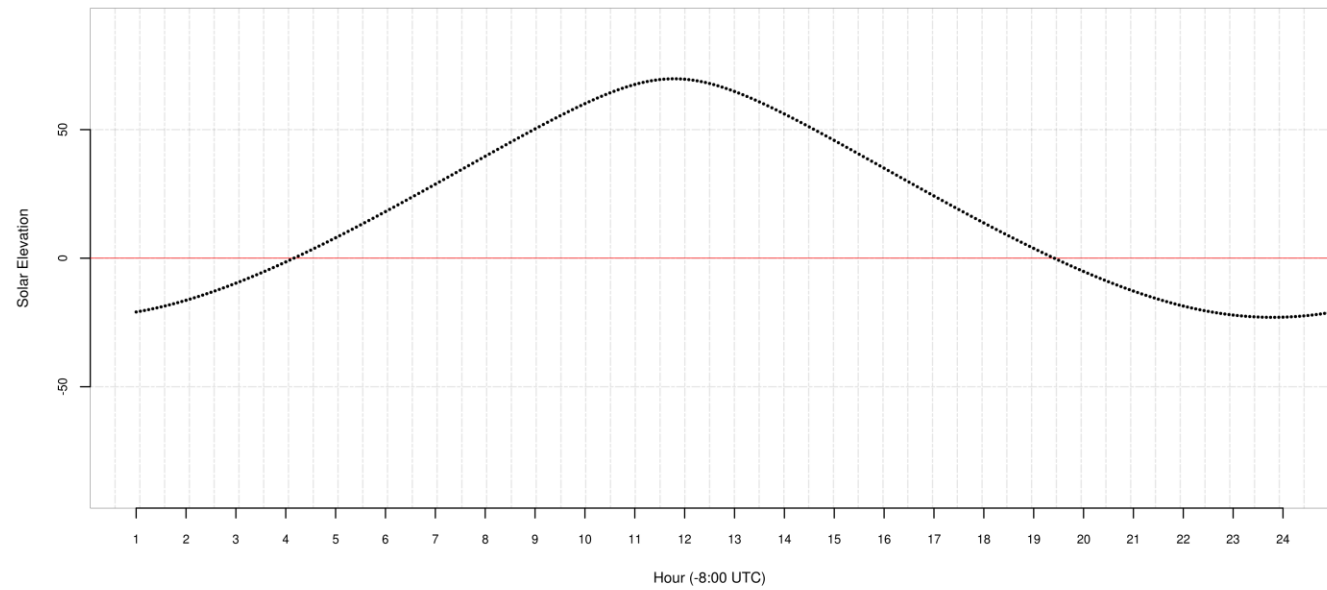



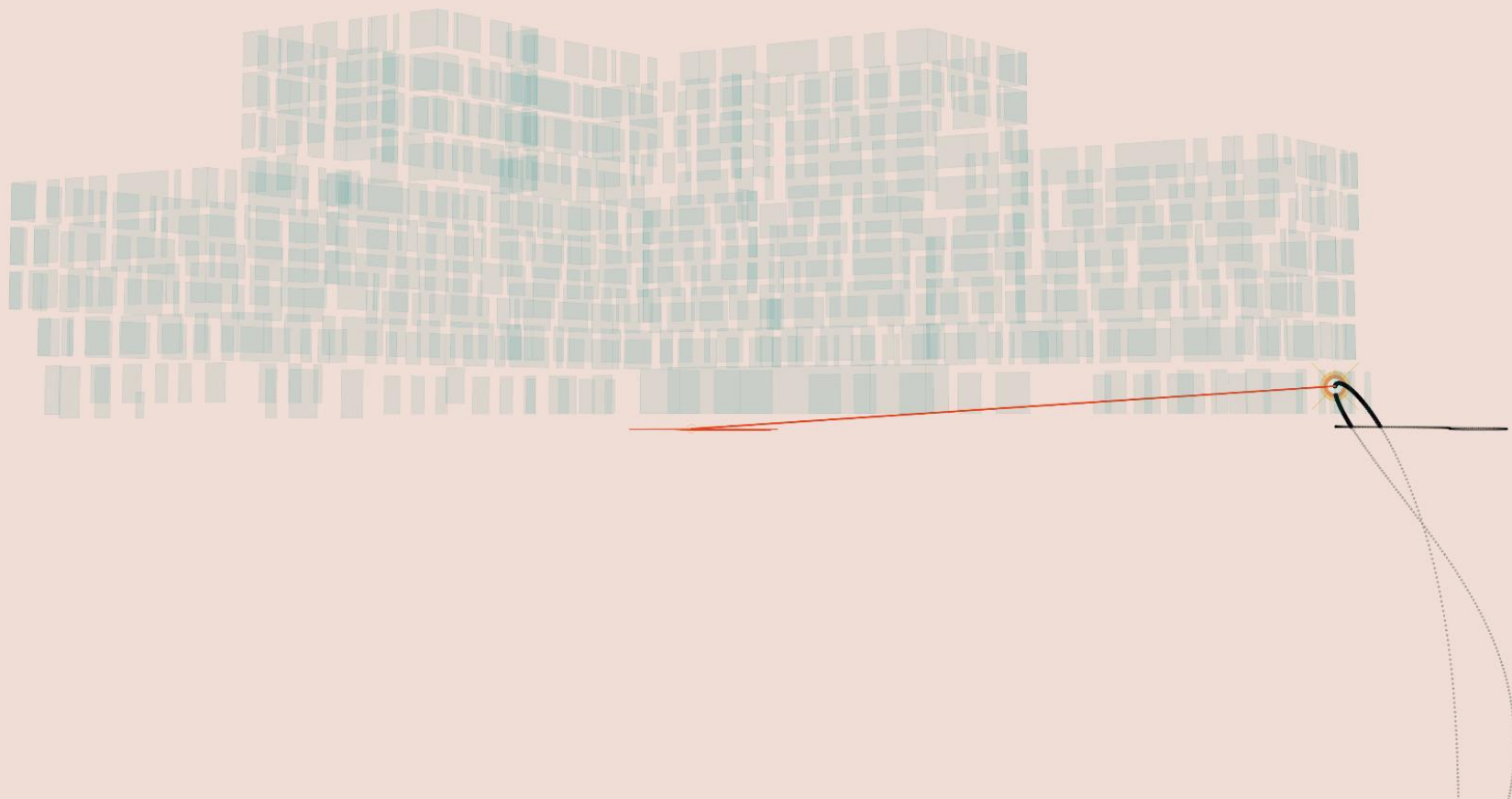

UNIVERSITY OF OREGON



UNIVERSITY OF OREGON



UNIVERSITY OF OREGON



UNIVERSITY OF OREGON



UNIVERSITY OF OREGON







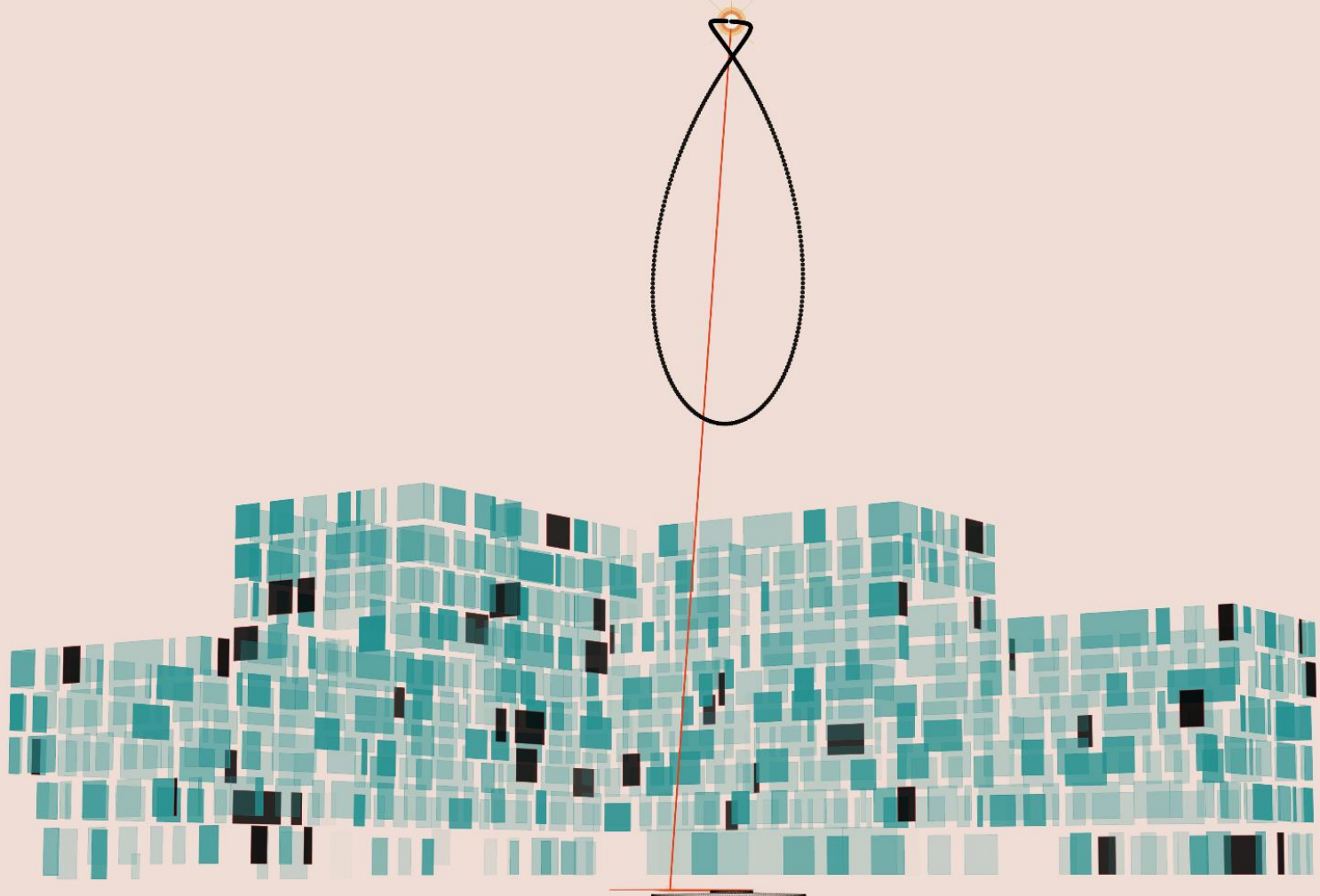

UNIVERSITY OF OREGON



UNIVERSITY OF OREGON

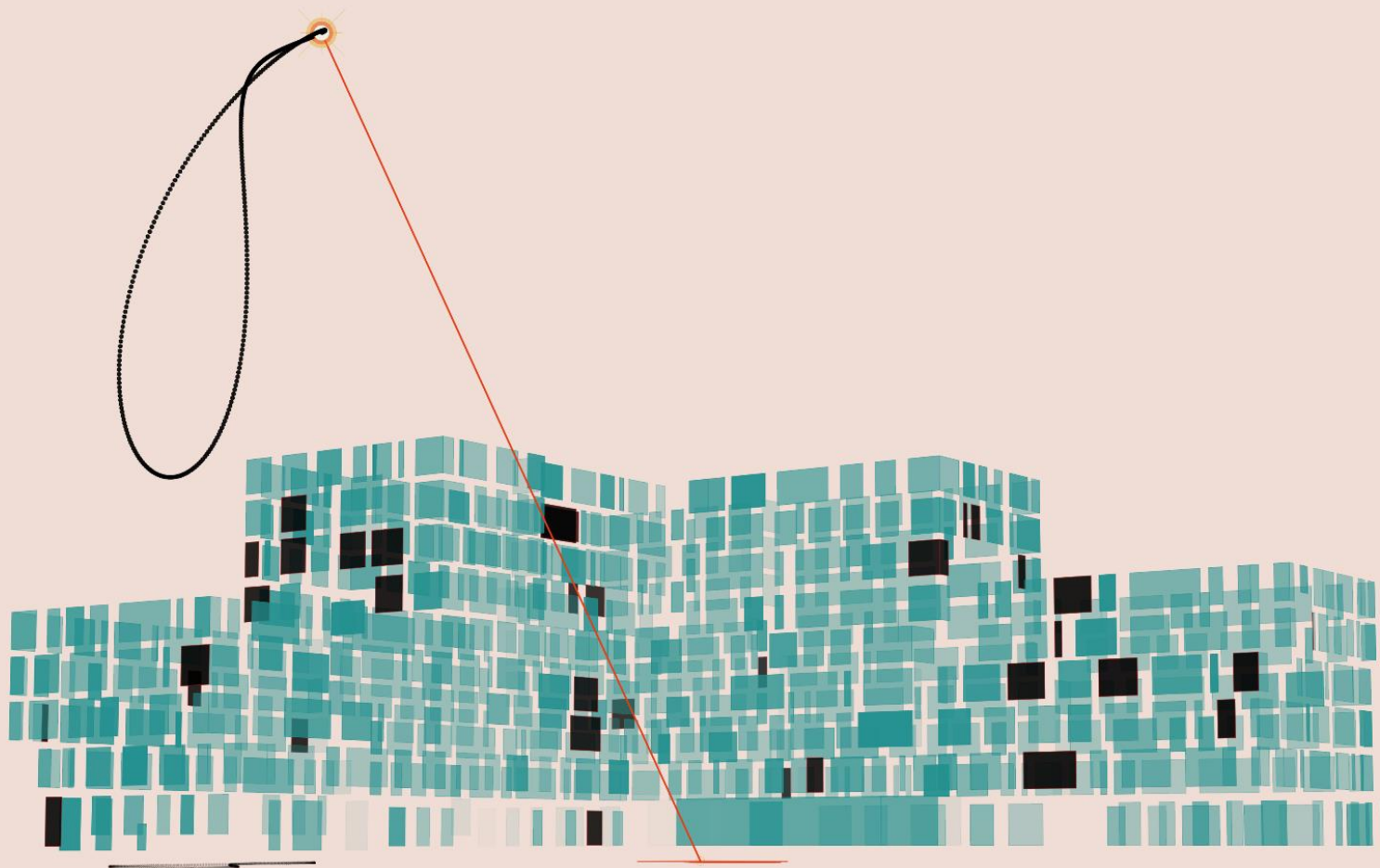

UNIVERSITY OF OREGON

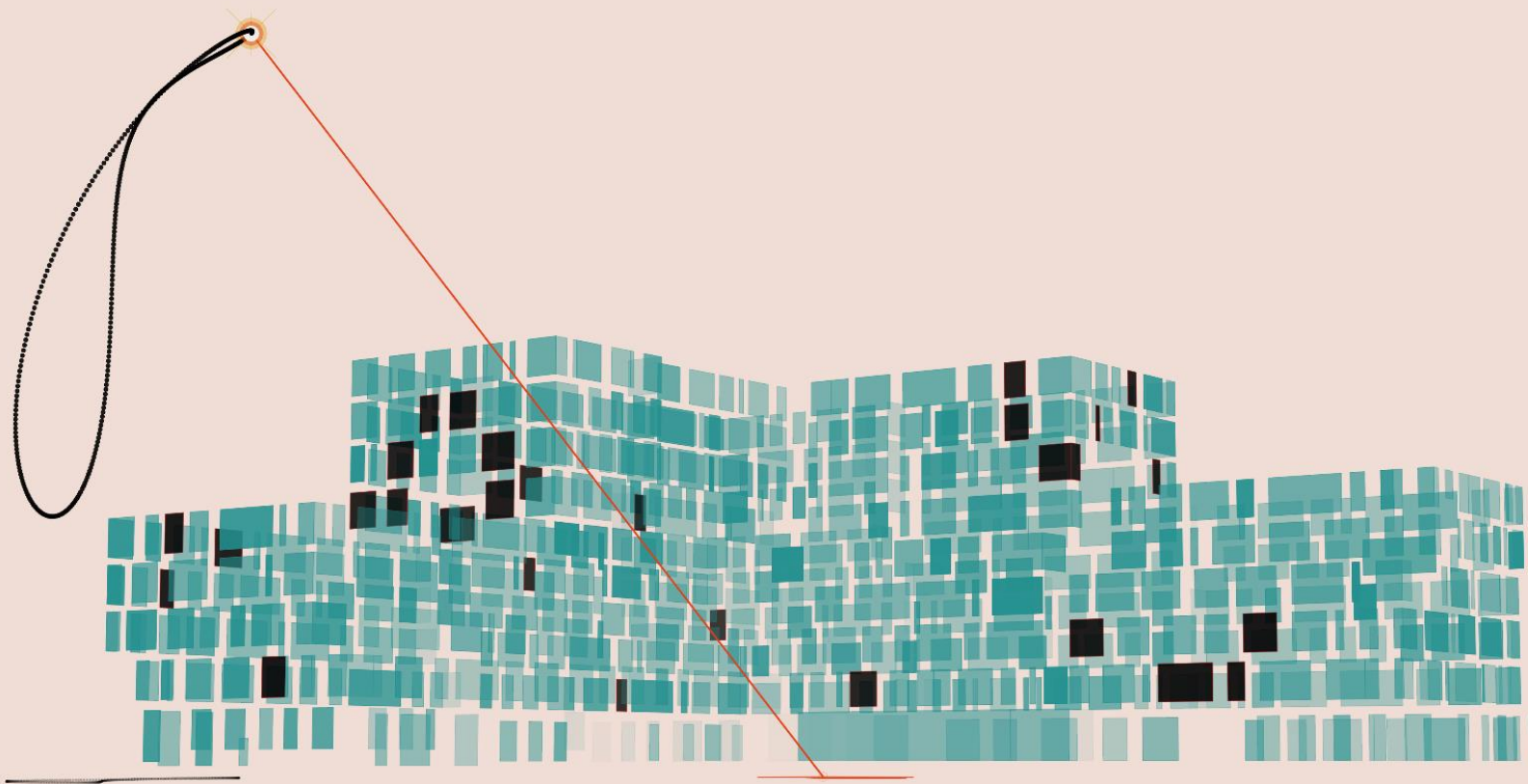

UNIVERSITY OF OREGON



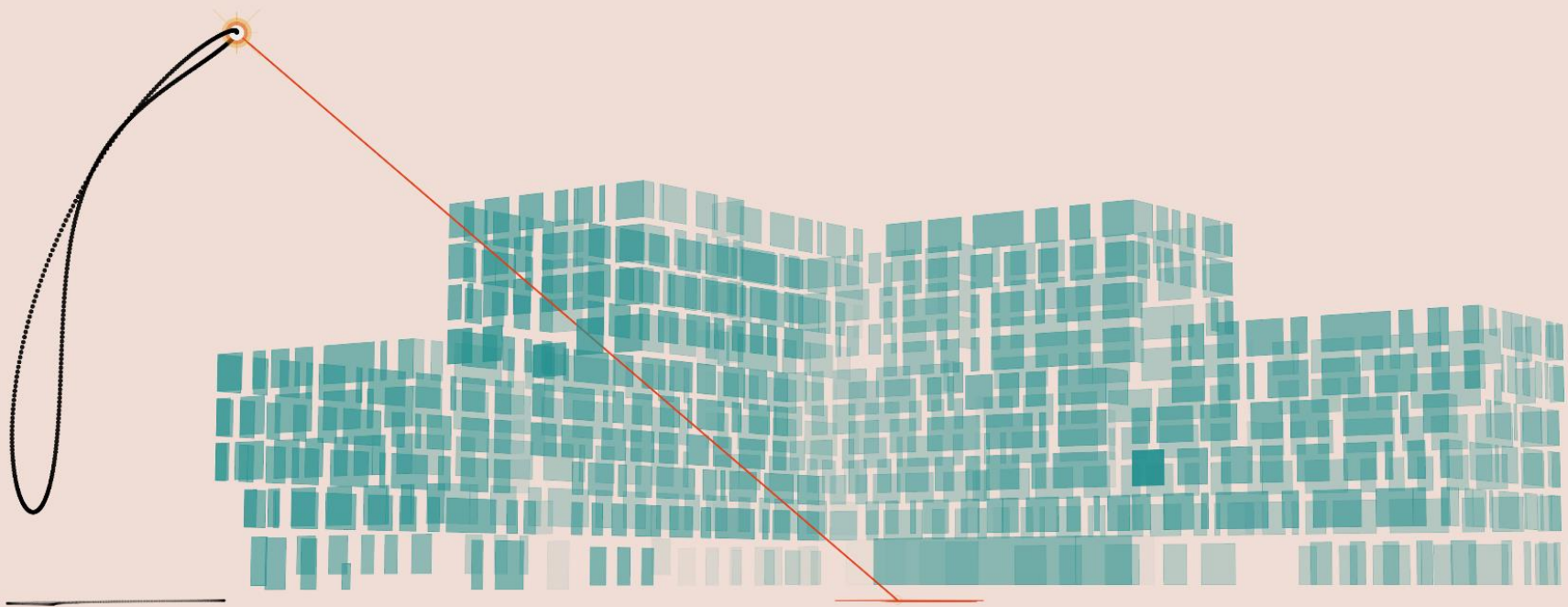

UNIVERSITY OF OREGON





UNIVERSITY OF OREGON



UNIVERSITY OF OREGON



UNIVERSITY OF OREGON

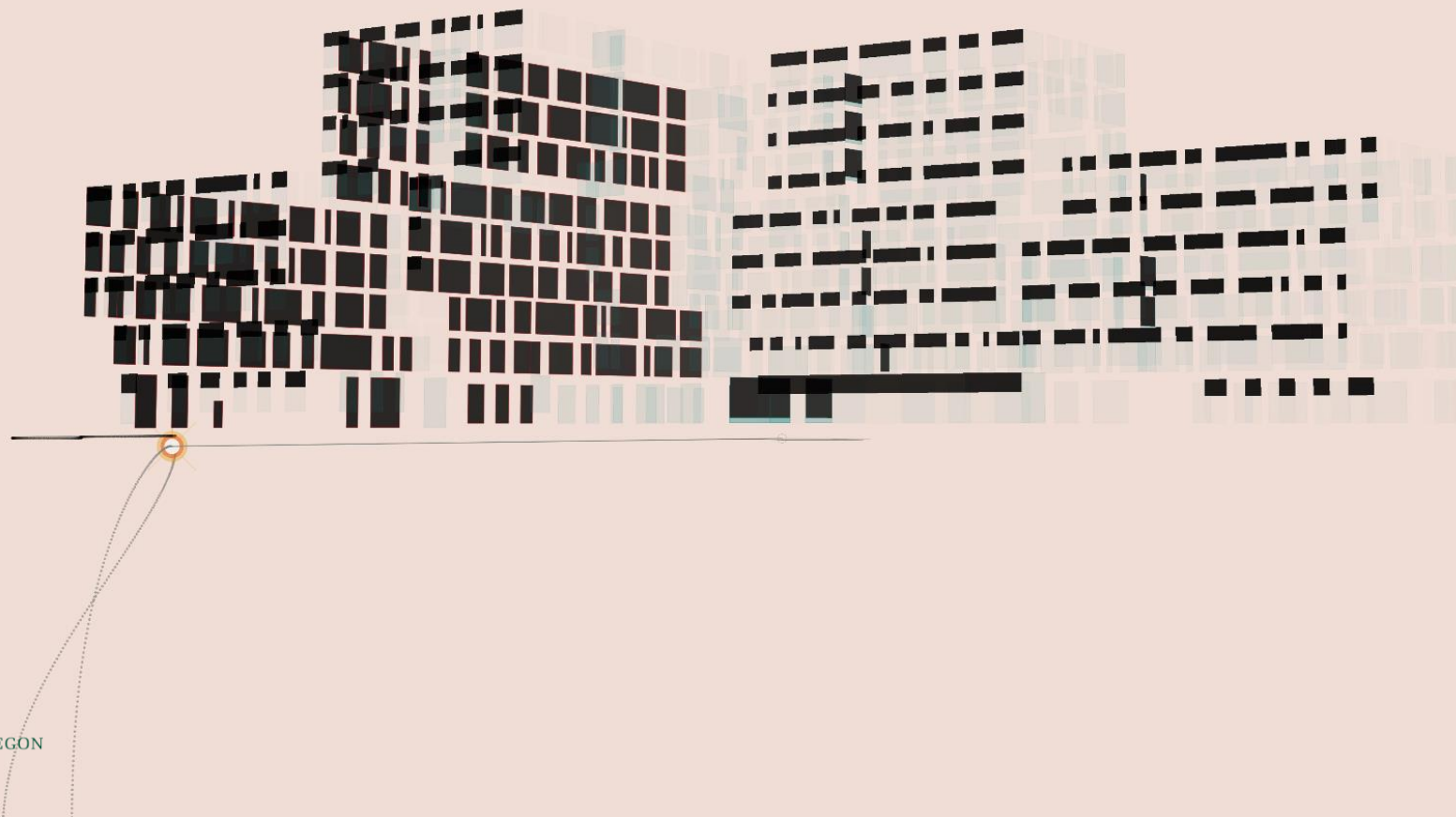

UNIVERSITY OF OREGON

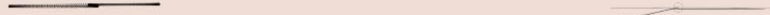

UNIVERSITY OF OREGON



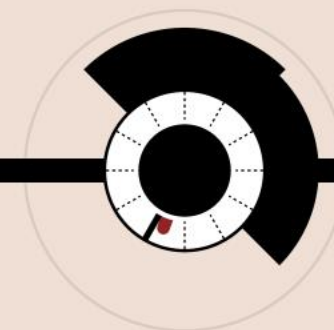

MONTH  
HOUR  
OCCLUSION



UNIVERSITY OF OREGON



## R building blocks

- Packages
  - sp -- Classes and methods for spatial data
  - plot3D -- Plotting multi-dimensional data
  - plot3Drgl -- Plotting multi-dimensional data in openGL
  - rgl -- 3D visualization using OpenGL
- Functions
  - svg(), png() to set up the file outputs.
  - perspbox() to set up the plot environment, min/max coordinate values.
  - plot(), plot3D(), polygon(), polygon3D() to plot sets of coordinates.
  - RGL-specific:
    - open3d() to initialize RGL.
    - rgl.bg() to set up 3D environment.
    - rgl.points(), rgl.lines(), rgl.spheres(), rgl.triangles(), rgl.quads() to plot and render various geometries.
    - rgl.viewpoint() and rgl.snapshot() to set up a point of view and save as an image file.



Animations available online:

[vimeo.com/142585361](https://vimeo.com/142585361) (*Full year*)

[vimeo.com/130748828](https://vimeo.com/130748828) (*RGL June short*)

[vimeo.com/130748827](https://vimeo.com/130748827) (*RGL January short*)



Thanks to all of our industry partners and great research staff that made this project happen!

And thank all of you for your time!

